

SEE PANEL 2250

SEE PANEL 2239

SEE PANEL 2243

SEE PANEL 2244

SEE PANEL 2263

KEY TO MAP

500-Year Flood Boundary	—	ZONE B
100-Year Flood Boundary	—	ZONE A1
Zone Designations*		ZONE A5
100-Year Flood Boundary	—	ZONE B
500-Year Flood Boundary	—	ZONE B
Base Flood Elevation Line With Elevation In Feet**	—57.3	
Base Flood Elevation in Feet Where Uniform Within Zone**	(EL 987)	
Elevation Reference Mark	RM7x	
Zone D Boundary	—	
River Mile	•M1.5	

**Referenced to the National Geodetic Vertical Datum of 1929

***EXPLANATION OF ZONE DESIGNATIONS**

ZONE	EXPLANATION
A	Areas of 100-year flood; base flood elevations and flood hazard factors not determined.
A0	Areas of 100-year shallow flooding where depths are between one (1) and three (3) feet; average depths of inundation are shown, but no flood hazard factors are determined.
AH	Areas of 100-year shallow flooding where depths are between one (1) and three (3) feet; base flood elevations are shown, but no flood hazard factors are determined.
A1-A30	Areas of 100-year flood; base flood elevations and flood hazard factors determined.
A99	Areas of 100-year flood to be protected by flood protection system under construction; base flood elevations and flood hazard factors not determined.
B	Areas between limits of the 100-year flood and 500-year flood; certain areas subject to 100-year flooding with average depths less than one (1) foot or where the contributing drainage area is less than one square mile; or areas protected by levees from the base flood. (Medium shading)
C	Areas of minimal flooding. (No shading)
D	Areas of undetermined, but possible, flood hazards.
V	Areas of 100-year coastal flood with velocity. (wave action); base flood elevations and flood hazard factors not determined.
V1-V30	Areas of 100-year coastal flood with velocity. (wave action); base flood elevations and flood hazard factors determined.

NOTES TO USER

Certain areas not in the special flood hazard areas (zones A and V) may be protected by flood control structures. This map is for flood insurance purposes only; it does not necessarily show all areas subject to flooding in the community or all planimetric features outside special flood hazard areas. For adjoining map panels, see separately printed Index To Map Panels.

INITIAL IDENTIFICATION:

FLOOD HAZARD BOUNDARY MAP REVISIONS: NOVEMBER 28, 1974
FLOOD INSURANCE RATE MAP EFFECTIVE: DECEMBER 15, 1981
FLOOD INSURANCE RATE MAP REVISIONS:

Refer to the FLOOD INSURANCE RATE MAP EFFECTIVE date shown on this map to determine when actuarial rates apply to structures in the zones where elevations or depths have been established. To determine if flood insurance is available in this community, contact your insurance agent, or call the National Flood Insurance Program, at (800) 638-6620.

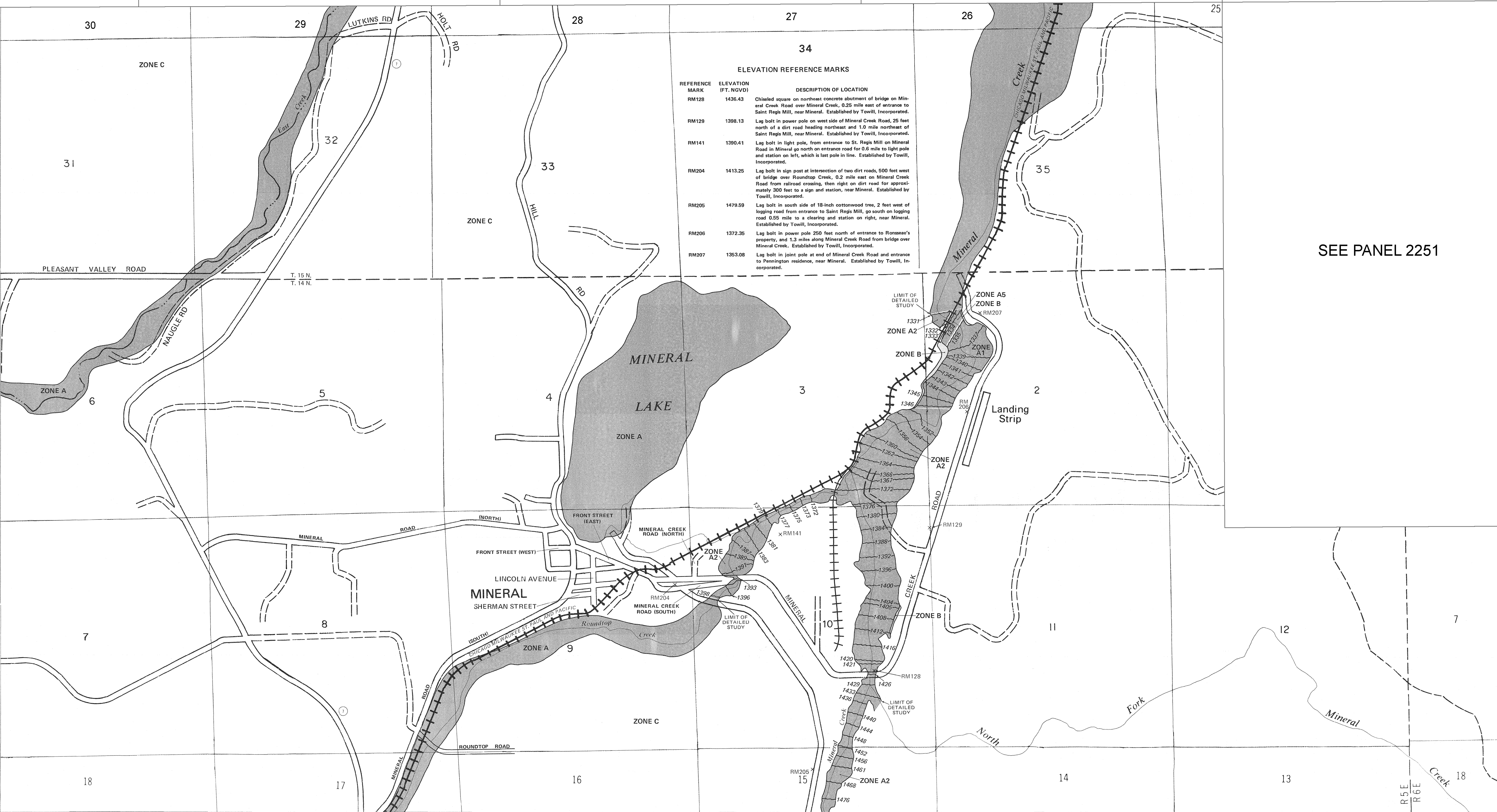
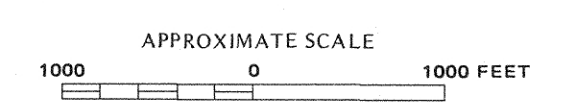

ELEVATION REFERENCE MARKS

REFERENCE MARK	ELEVATION (FT. NGVD)	DESCRIPTION OF LOCATION
RM128	1436.43	Chiseled square on northeast concrete abutment of bridge on Mineral Creek Road over Mineral Creek, 0.25 mile east of entrance to Saint Regis Mill, near Mineral. Established by Towill, Incorporated.
RM129	1388.13	Lag bolt in power pole on west side of Mineral Creek Road, 25 feet north of a dirt road heading northeast and 1.0 mile northeast of Saint Regis Mill, near Mineral. Established by Towill, Incorporated.
RM141	1390.41	Lag bolt in light pole, from entrance to St. Regis Mill on Mineral Road in Mineral go north on entrance road for 0.6 mile to light pole and station on left, which is last pole in line. Established by Towill, Incorporated.
RM204	1413.25	Lag bolt in sign post at intersection of two dirt roads, 500 feet west of bridge over Roundtop Creek, 0.2 mile east on Mineral Creek Road from railroad crossing, then right on dirt road for approximately 300 feet to a sign and station, near Mineral. Established by Towill, Incorporated.
RM205	1479.59	Lag bolt in south side of 18-inch cottonwood tree, 2 feet west of logging road from entrance to Saint Regis Mill, go south on logging road 0.55 mile to a clearing and station on right, near Mineral. Established by Towill, Incorporated.
RM206	1372.35	Lag bolt in power pole 250 feet north of entrance to Ronseaux's property, and 1.3 miles along Mineral Creek Road from bridge over Mineral Creek. Established by Towill, Incorporated.
RM207	1353.08	Lag bolt in joint pole at end of Mineral Creek Road and entrance to Pennington residence, near Mineral. Established by Towill, Incorporated.

JOINS PANEL 0115

JOINS PANEL 0310

JOINS PANEL 0110

NATIONAL FLOOD INSURANCE PROGRAM

FIRM FLOOD INSURANCE RATE MAP

LEWIS COUNTY, WASHINGTON (UNINCORPORATED AREAS)

PANEL 120 OF 800 (SEE MAP INDEX FOR PANELS NOT PRINTED) PRELIMINARY 6/25/2021

COMMUNITY-PANEL NUMBER 530102 0120C

MAP REVISED:



Federal Emergency Management Agency