

45° 37'30.02" N,  
121° 00'05" W

45° 37'30.02" N,  
120° 52'30.05" W

45° 30'0.02" N,  
121° 00'05" W

45° 30'0.02" N,  
120° 52'30.05" W

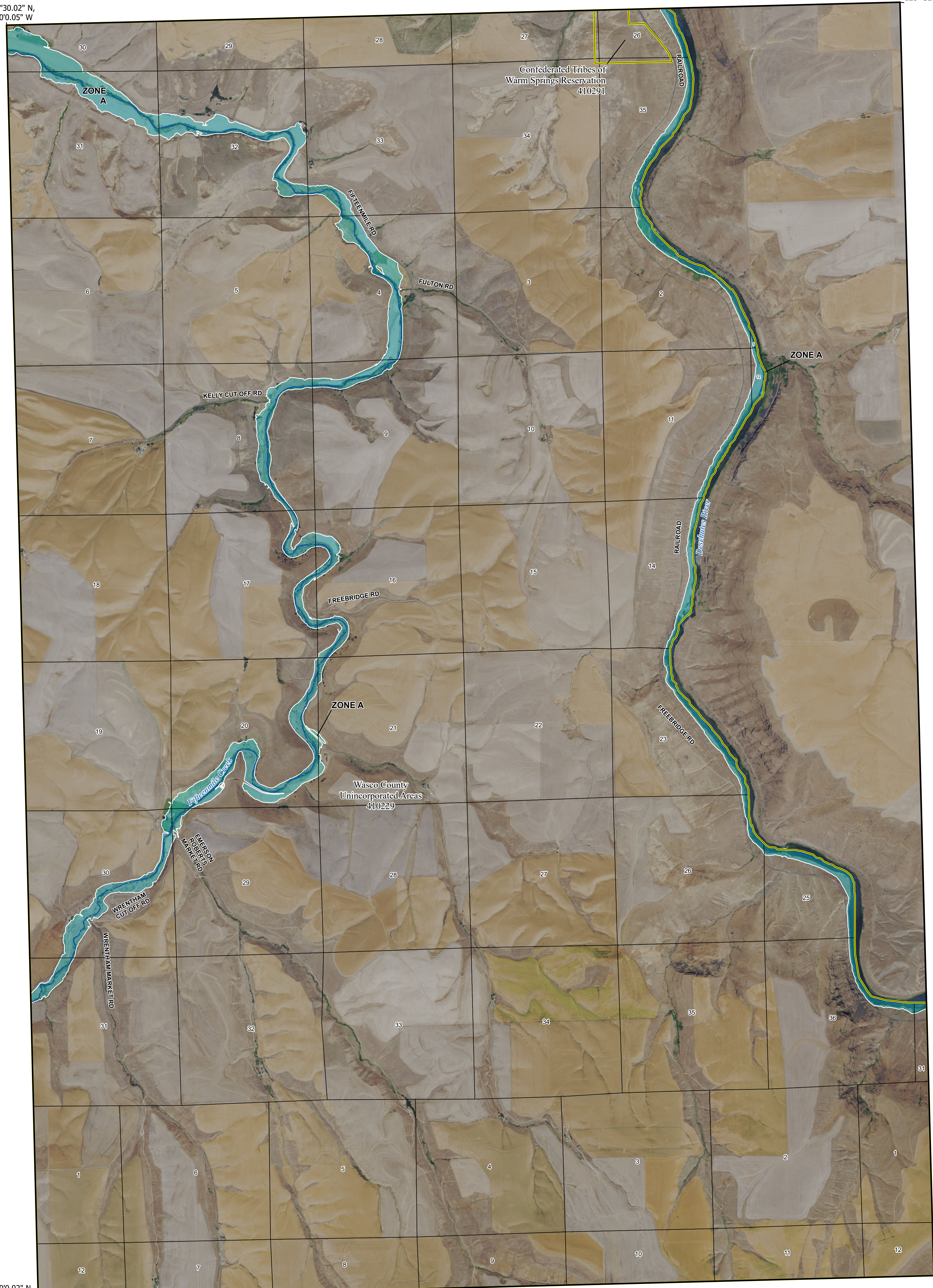

### FLOOD HAZARD INFORMATION

SEE FIS REPORT FOR DETAILED LEGEND AND INDEX MAP FOR FIRM PANEL LAYOUT  
**THE INFORMATION DEPICTED ON THIS MAP AND SUPPORTING DOCUMENTATION ARE ALSO AVAILABLE IN DIGITAL FORMAT AT [HTTPS://MSC.FEMA.GOV](https://MSC.FEMA.GOV)**

<b>SPECIAL FLOOD HAZARD AREAS</b>		Without Base Flood Elevation (BFE) Zone A, V, A99
		With BFE or Depth Zone AE, AO, AH, VE, AR
		Regulatory Floodway
<b>OTHER AREAS OF FLOOD HAZARD</b>		0.2% Annual Chance Flood Hazard, Areas of 1% annual chance flood with average depth less than one foot or with drainage areas of less than one square mile Zone X
		Future Conditions 1% Annual Chance Flood Hazard Zone X
		Area with Reduced Flood Risk due to Levee See Notes Zone X
		Area with Flood Risk due to Levee Zone D
<b>OTHER AREAS</b>		NO SCREEN Area of Minimal Flood Hazard Zone X
		Area of Undetermined Flood Hazard Zone D
<b>GENERAL STRUCTURES</b>		Channel, Culvert, or Storm Sewer
		Levee, Dike, or Floodwall
		Cross Sections with 1% Annual Chance 20.2
		Water Surface Elevation 17.5
		Coastal Transect
		Coastal Transect Baseline
		Profile Baseline
		Hydrographic Feature
<b>OTHER FEATURES</b>		Base Flood Elevation Line (BFE)
		Limit of Study
		Jurisdiction Boundary

### NOTES TO USERS

For information and questions about this Flood Insurance Rate Map (FIRM), available effective flood hazard information for your community, or the National Flood Insurance Program (NFIP) in general, please call the FEMA Mapping and Insurance Information Exchange at 1-877-FEMA-MAP (1-877-336-2627) or visit the FEMA Flood Map Service Center website at <https://msc.fema.gov>. Available products may include previously issued Letters of Map Change, a Flood Insurance Study Report, and/or digital versions of this map. Many of these products can be downloaded from the website. Communities annexing land on adjacent FIRM panels must obtain a current copy of the adjacent panel as well as the current FIRM Index. These may be acquired directly from the Flood Map Service Center at the website listed above.

For community and countywide map dates refer to the Flood Insurance Study Report for this jurisdiction.

To determine if flood insurance is available in this community, contact your insurance agent or call the National Flood Insurance Program at 1-800-638-6620.

Basemap information shown on this FIRM was provided in digital format by the United States Geological Survey (USGS). The basemap shown is the USGS National Map: Orthoimagery, Last refreshed October, 2020.

Note: Some Special Flood Hazard Areas with elevations may not appear with elevation labels if the Base Flood Elevation or Cross-section line which communicates the elevation for the location appears on the adjacent panel. Please see the Panel Locator Diagram on this map panel to determine the adjacent panel and find the elevation feature there, or alternatively use the Flood Insurance Study report for detailed elevations by flood source.

### SCALE

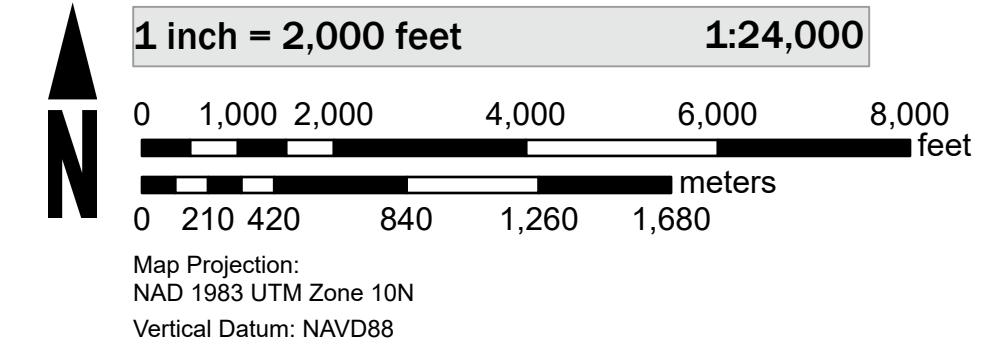

### PANEL LOCATOR

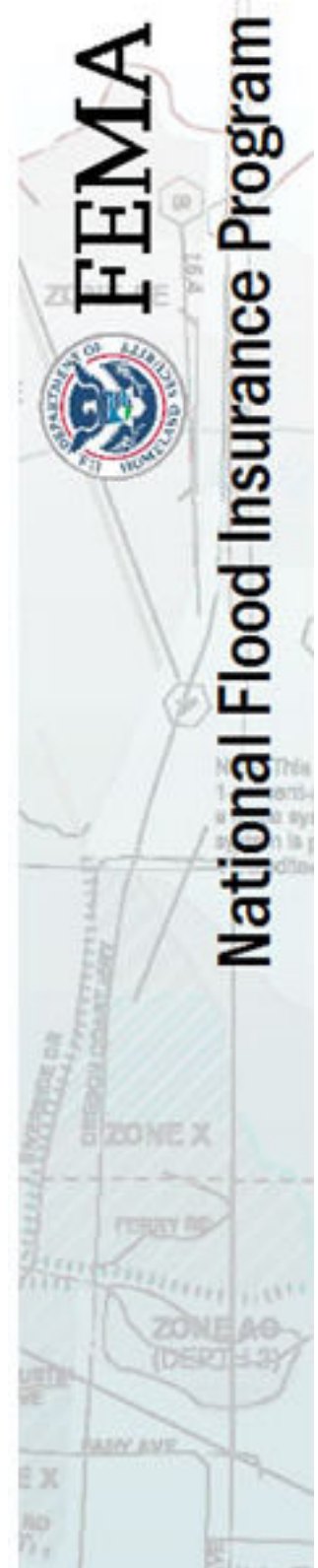
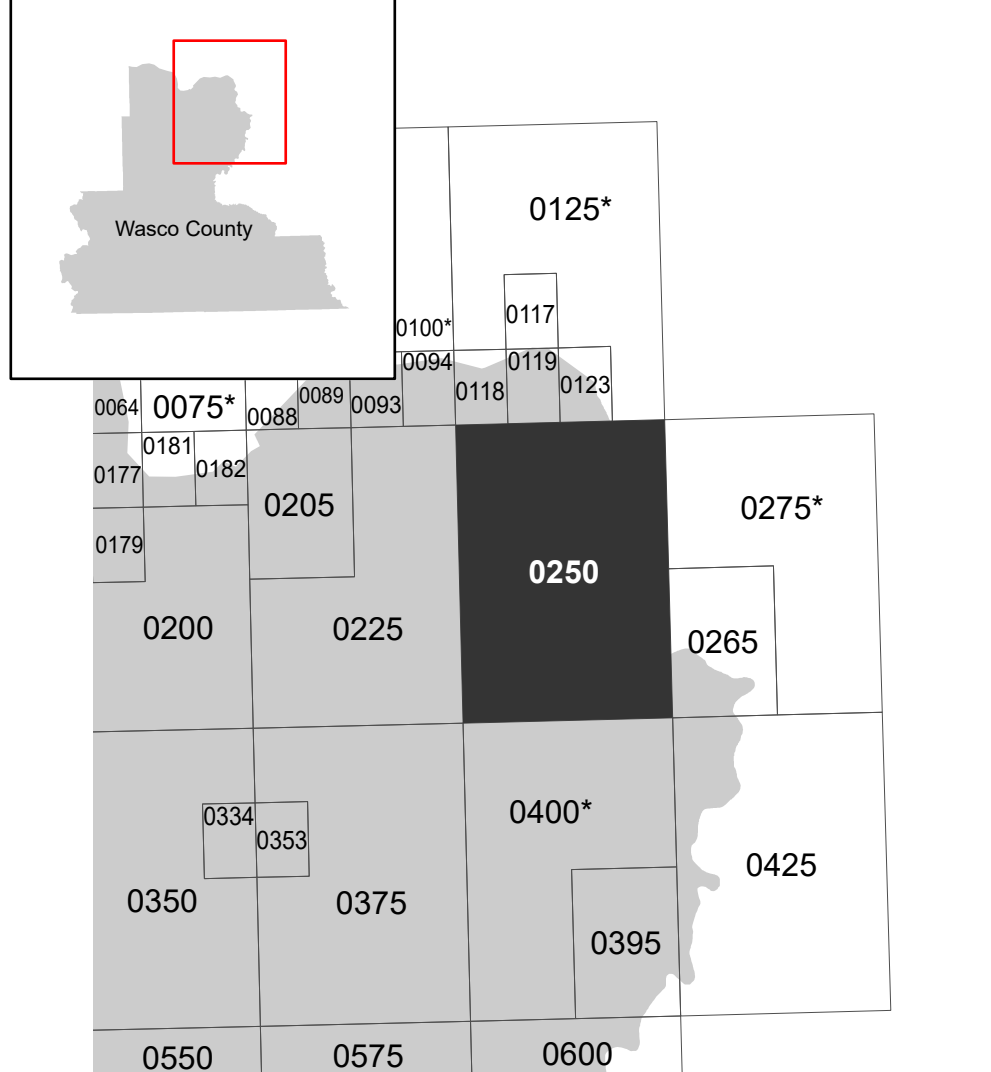

**NATIONAL FLOOD INSURANCE PROGRAM**  
 FLOOD INSURANCE RATE MAP  
**WASCO COUNTY, OREGON AND INCORPORATED AREAS**

Panel Contains:

COMMUNITY	NUMBER	PANEL SUFFIX
CONFEDERATED TRIBES OF WARM SPRINGS RESERVATION	410291	0250 C
WASCO COUNTY UNINCORPORATED AREAS	410229	0250 C

MAP NUMBER  
**41065C0250C**  
 EFFECTIVE DATE  
 Prelim Issue Date: 10/14/2022

\*PANEL NOT PRINTED