

FLOOD HAZARD INFORMATION

SEE FIS REPORT FOR ZONE DESCRIPTIONS AND INDEX MAP
THE INFORMATION DEPICTED ON THIS MAP AND SUPPORTING DOCUMENTATION ARE ALSO AVAILABLE IN DIGITAL FORMAT AT [HTTP://MSC.FEMA.GOV](http://msc.fema.gov)

| | | |
|------------------------------------|--|---|
| SPECIAL FLOOD HAZARD AREAS | | Without Base Flood Elevation (BFE) Zone A, V, A99 |
| | | With BFE or Depth Zone AE, AO, AH, VE, AR |
| | | Regulatory Floodway |
| OTHER AREAS OF FLOOD HAZARD | | 0.2% Annual Chance Flood Hazard, Areas of 1% annual chance flood with average depth less than one foot or with drainage areas of less than one square mile Zone X |
| | | Future Conditions 1% Annual Chance Flood Hazard Zone X |
| | | Area with Reduced Flood Risk due to Levee See Notes. Zone X |
| OTHER AREAS | | Areas of Minimal Flood Hazard Zone X |
| | | Area of Undetermined Flood Hazard Zone D |
| GENERAL STRUCTURES | | Channel, Culvert, or Storm Sewer |
| | | Accredited or Provisionally Accredited Levee, Dike, or Floodwall |
| | | Non-accredited Levee, Dike, or Floodwall |
| | | Cross Sections with 1% Annual Chance Water Surface Elevation (BFE) 18.2, 17.5 |
| | | Coastal Transect |
| | | Coastal Transect Baseline |
| | | Profile Baseline |
| | | Hydrographic Feature |
| | | Base Flood Elevation Line (BFE) 513 |
| OTHER FEATURES | | Limit of Study |
| | | Jurisdiction Boundary |

NOTES TO USERS

For information and questions about this map, available products associated with this FIRM including historic versions of this FIRM, how to order products or the National Flood Insurance Program in general, please call the FEMA Map Information eXchange at 1-877-FEMA-MAP (1-877-336-2627) or visit the FEMA Map Service Center website at <http://msc.fema.gov>. Available products may include previously issued Letters of Map Change, a Flood Insurance Study Report, and/or digital versions of this map. Many of these products can be ordered or obtained directly from the website. Users may determine the current map date for each FIRM panel by visiting the FEMA Map Service Center website or by calling the FEMA Map Information eXchange.

Communities annexing land on adjacent FIRM panels must obtain a current copy of the adjacent panel as well as the current FIRM Index. These may be ordered directly from the Map Service Center at the number listed above.

For community and countywide map dates refer to the Flood Insurance Study report for this jurisdiction. To determine if flood insurance is available in the community, contact your insurance agent or call the National Flood Insurance Program at 1-800-638-6620.

Base map information shown on this FIRM was provided in digital format by the United States Geological Survey (USGS), Logan County, and Ohio Department of Natural Resources. This information was derived from digital orthophotography at a 1-foot resolution from photography dated 2007.

SCALE

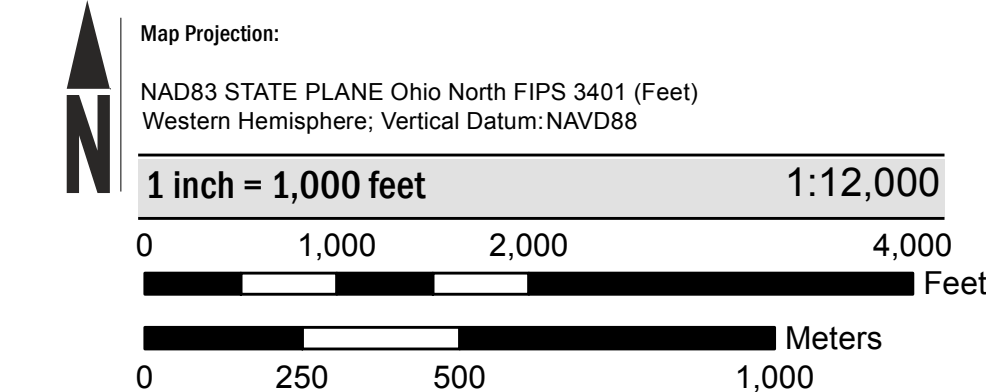

PANEL LOCATOR

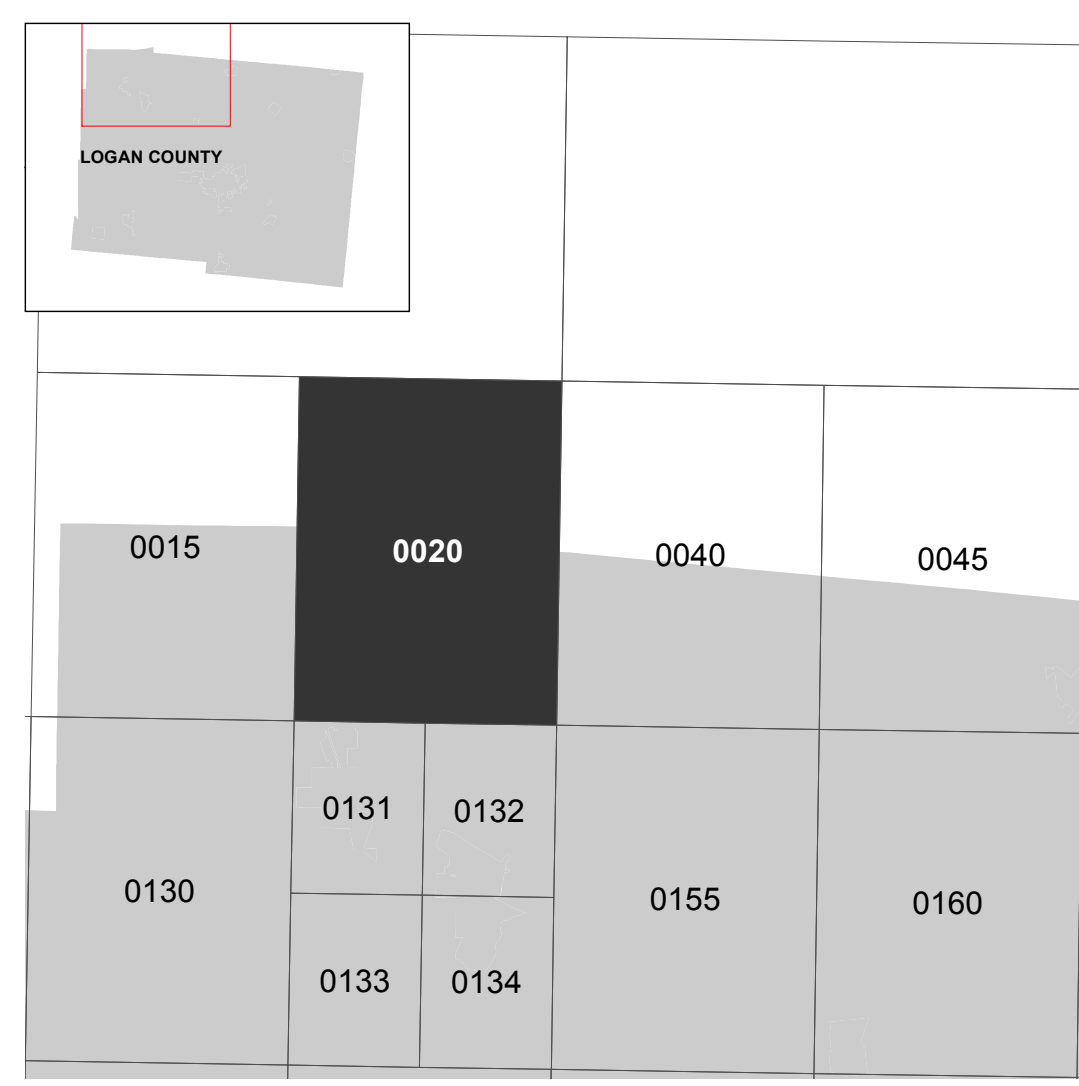

National Flood Insurance Program

NATIONAL FLOOD INSURANCE PROGRAM
 FLOOD INSURANCE RATE MAP

LOGAN COUNTY, OHIO
 And Incorporated Areas

PANEL 020 OF 425

FEMA

PRELIMINARY
APRIL 30 2014

Panel Contains:

| COMMUNITY | NUMBER | PANEL SUFFIX |
|--------------|--------|--------------|
| LOGAN COUNTY | 390772 | 0020 E |

VERSION NUMBER
1.1.1.1

MAP NUMBER
39091C0020E

EFFECTIVE DATE