

**FLOOD HAZARD INFORMATION**

SEE FIS REPORT FOR DETAILED LEGEND AND INDEX MAP FOR FIRM PANEL LAYOUT  
**THE INFORMATION DEPICTED ON THIS MAP AND SUPPORTING DOCUMENTATION ARE ALSO AVAILABLE IN DIGITAL FORMAT AT**  
[HTTP://MSC.FEMA.GOV](http://MSC.FEMA.GOV)

<b>SPECIAL FLOOD HAZARD AREAS</b>		Without Base Flood Elevation (BFE) Zone A, V, A99
		With BFE or Depth Zone AE, AO, AH, VE, AR
		Regulatory Floodway
		0.2% Annual Chance Flood Hazard, Areas of 1% annual chance flood with average depth less than one foot or with drainage areas of less than one square mile Zone X
		Future Conditions 1% Annual Chance Flood Hazard Zone X
<b>OTHER AREAS OF FLOOD HAZARD</b>		Area with Reduced Flood Risk due to Levee See Notes. Zone X
		Area with Flood Risk due to Levee Zone D
<b>OTHER AREAS</b>		Area of Minimal Flood Hazard Zone X
		Area of Undetermined Flood Hazard Zone D
<b>GENERAL STRUCTURES</b>		Channel, Culvert, or Storm Sewer
		Levee, Dike, or Floodwall
		Cross Sections with 1% Annual Chance Water Surface Elevation
		Coastal Transect
		Coastal Transect Baseline
		Profile Baseline
		Hydrographic Feature
		Base Flood Elevation Line (BFE)
<b>OTHER FEATURES</b>		Limit of Study
		Jurisdiction Boundary

**NOTES TO USERS**

For information and questions about this map, available products associated with this FIRM including historic versions of this FIRM, how to order products or the National Flood Insurance Program in general, please call the FEMA Map Information eXchange at 1-877-FEMA-MAP (1-877-336-2627) or visit the FEMA Map Service Center website at <https://msc.fema.gov>. Available products may include previously issued Letters of Map Change, a Flood Insurance Study Report, and/or digital versions of this map. Many of these products can be ordered or obtained directly from the website. Users may determine the current map date for each FIRM panel by visiting the FEMA Map Service Center website or by calling the FEMA Map Information eXchange.

Communities annexing land on adjacent FIRM panels must obtain a current copy of the adjacent panel as well as the current FIRM Index. These may be ordered directly from the Map Service Center at the number listed above.

For community and countywide map dates refer to the Flood Insurance Study report for this jurisdiction. To determine if flood insurance is available in this community, contact your insurance agent or call the National Flood Insurance Program at 1-800-638-6620.

Base map information shown on this FIRM was derived from multiple sources. This information was photogrammetrically compiled at a scale of 1"=100' from aerial photography dated 2016.

**SCALE**

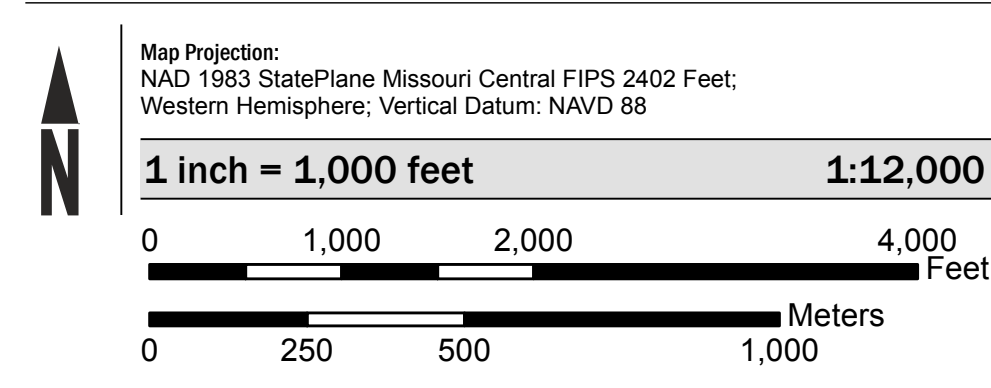

**PANEL LOCATOR**

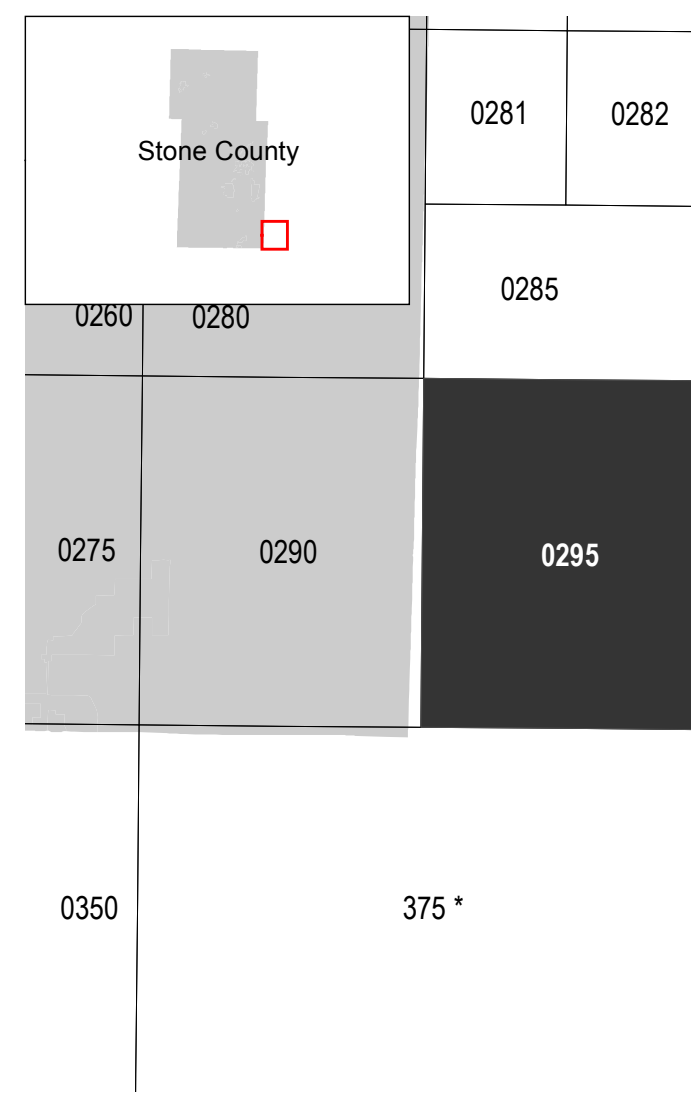

\* PANEL NOT PRINTED

**NATIONAL FLOOD INSURANCE PROGRAM**  
 FLOOD INSURANCE RATE MAP

STONE COUNTY,  
 MISSOURI  
 and Incorporated Areas  
 PANEL 295 of 375



Panel Contains:  
 COMMUNITY      NUMBER      PANEL      SUFFIX



**PRELIMINARY**  
 8/6/2019

VERSION NUMBER  
 2.4.3.5  
 MAP NUMBER  
 29209C0295D  
 MAP REVISED