

36° 56'15.08" N,
92° 41'15.02" W

36° 56'15.08" N,
92° 39'22.52" W
Prairie Creek Tributary
ZONE AE



36° 54'22.54" N,
92° 41'15.02" W

36° 54'22.54" N,
92° 39'22.52" W

USGS, USDA

FLOOD HAZARD INFORMATION

SEE FIS REPORT FOR DETAILED LEGEND AND INDEX MAP FOR FIRM PANEL LAYOUT
THE INFORMATION DEPICTED ON THIS MAP AND SUPPORTING
DOCUMENTATION ARE ALSO AVAILABLE IN DIGITAL FORMAT AT
[HTTPS://MSC.FEMA.GOV](https://MSC.FEMA.GOV)

SPECIAL FLOOD HAZARD AREAS		Without Base Flood Elevation (BFE) Zone A, V, AE9
		With BFE or Depth Zone AE, AO, AH, VE, AR
OTHER AREAS OF FLOOD HAZARD		Regulatory Floodway
		0.2% Annual Chance Flood Hazard, Areas of 1% annual chance flood with average depth less than one foot or with drainage areas of less than one square mile Zone X
		Future Conditions 1% Annual Chance Flood Hazard Zone X
		Area with Reduced Flood Risk due to Levee See Notes Zone X
OTHER AREAS		Area with Flood Risk due to Levee Zone D
		Area of Minimal Flood Hazard Zone X
GENERAL STRUCTURES		Area of Undetermined Flood Hazard Zone D
		Channel, Culvert, or Storm Sewer
OTHER FEATURES		Levee, Dike, or Floodwall
		Cross Sections with 1% Annual Chance
		Water Surface Elevation
		Coastal Transect
		Coastal Transect Baseline
OTHER FEATURES		Profile Baseline
		Hydrographic Feature
		Base Flood Elevation Line (BFE)
		Limit of Study
		Jurisdiction Boundary

NOTES TO USERS

For information and questions about this Flood Insurance Rate Map (FIRM), available effective flood hazard information for your community, or the National Flood Insurance Program (NFIP) in general, please call the FEMA Mapping and Insurance eXchange at 1-877-FEMA-MAP (1-877-336-2627) or visit the FEMA Flood Map Service Center website at <https://msc.fema.gov>. Available products may include previously issued Letters of Map Change, a Flood Insurance Study Report, and/or digital versions of this map. Many of these products can be downloaded from the website. Communities annexing land on adjacent FIRM panels must obtain a current copy of the adjacent panel as well as the current FIRM Index. These may be acquired directly from the Flood Map Service Center at the website listed above.

For community and countywide map dates refer to the Flood Insurance Study Report for this jurisdiction. To determine if flood insurance is available in this community, contact your insurance agent or call the National Flood Insurance Program at 1-800-638-6620.

Basemap information shown on this FIRM was provided in digital format by the United States Geological Survey (USGS). The basemap shown is the USGS National Map: Orthimagery, Last refreshed October, 2020.

Note: Some Special Flood Hazard Areas with elevations may not appear with elevation labels if the Base Flood Elevation or Cross-section line which communicates the elevation for the location appears on the adjacent panel. Please see the Panel Locator Diagram on this map panel to determine the adjacent panel and find the elevation feature there, or alternatively use the Flood Insurance Study report for detailed elevations by flood source.

SCALE

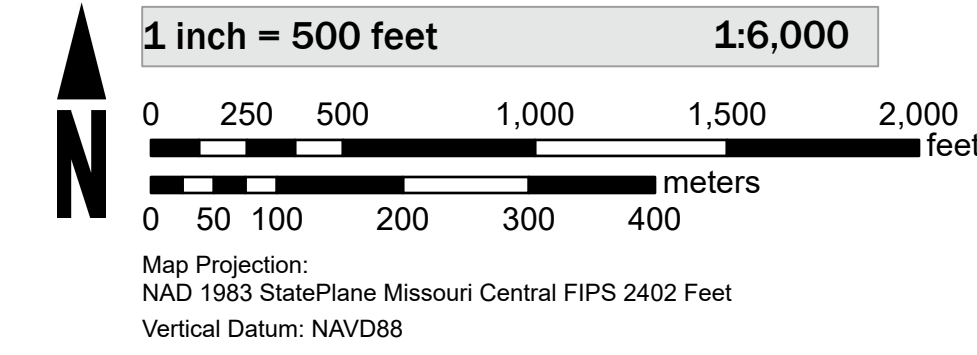

PANEL LOCATOR

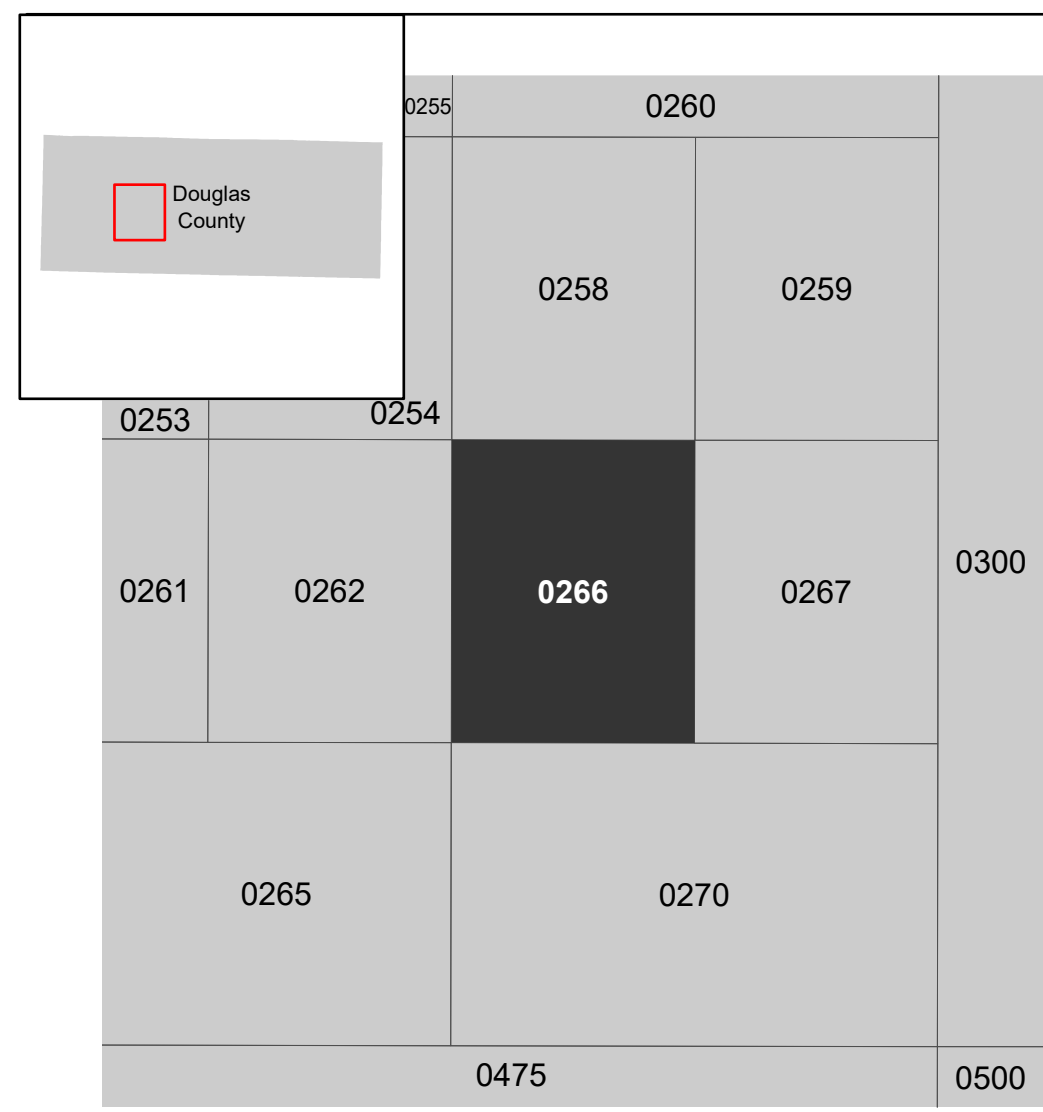

National Flood Insurance Program

NATIONAL FLOOD INSURANCE PROGRAM
FLOOD INSURANCE RATE MAP

DOUGLAS COUNTY MISSOURI AND INCORPORATED AREAS

Panel Contains:

COMMUNITY	NUMBER	PANEL	SUFFIX
DOUGLAS COUNTY UNINCORPORATED AREAS	290800	0266	C
CITY OF AVA	290121	0266	C

MAP NUMBER
2906700266C
EFFECTIVE DATE
Prelim Issue Date: 07/17/2024