

37° 7'30.02" N,
90° 0'0.02" W

37° 7'30.02" N,
89° 58'7.52" W



37° 5'37.52" N,
90° 0'0.02" W

37° 5'37.52" N,
89° 58'7.52" W

USGS, USDA

FLOOD HAZARD INFORMATION

SEE FIS REPORT FOR DETAILED LEGEND AND INDEX MAP FOR FIRM PANEL LAYOUT
THE INFORMATION DEPICTED ON THIS MAP AND SUPPORTING DOCUMENTATION ARE ALSO AVAILABLE IN DIGITAL FORMAT AT [HTTPS://MSC.FEMA.GOV](https://MSC.FEMA.GOV)

	Without Base Flood Elevation (BFE) Zone A, V, AE, AO, AH, VE, AR
	With BFE or Depth Zone AE, AO, AH, VE, AR
	Regulatory Floodway
	0.2% Annual Chance Flood Hazard, Areas of 1% annual chance flood with average depth less than one foot or with drainage areas of less than one square mile Zone X
	Future Conditions 1% Annual Chance Flood Hazard Zone X
	Area with Reduced Flood Risk due to Levee See Notes Zone X
	Area with Flood Risk due to Levee Zone D
	Area of Minimal Flood Hazard Zone X
	Area of Undetermined Flood Hazard Zone D
	Channel, Culvert, or Storm Sewer
	Levee, Dike, or Floodwall
	20.2 Cross Sections with 1% Annual Chance
	17.5 Water Surface Elevation
	Coastal Transect
	Coastal Transect Baseline
	Profile Baseline
	Hydrographic Feature
	Base Flood Elevation Line (BFE)
	Limit of Study
	Jurisdiction Boundary

NOTES TO USERS

For information and questions about this Flood Insurance Rate Map (FIRM), available effective flood hazard information for your community, or the National Flood Insurance Program (NFIP) in general, please call the FEMA Mapping and Insurance Information Exchange at 1-877-FEMA-MAP (1-877-336-2627) or visit the FEMA Flood Map Service Center website at <https://msc.fema.gov>. Available products may include previously issued Letters of Map Change, a Flood Insurance Study Report, and/or digital versions of this map. Many of these products can be downloaded from the website. Communities annexing land on adjacent FIRM panels must obtain a current copy of the adjacent panel as well as the current FIRM Index. These may be acquired directly from the Flood Map Service Center at the website listed above.

For community and countywide map dates refer to the Flood Insurance Study Report for this jurisdiction.
 To determine if flood insurance is available in this community, contact your insurance agent or call the National Flood Insurance Program at 1-800-638-6620.

Basemap information shown on this FIRM was provided in digital format by the United States Geological Survey (USGS). The basemap shown is the USGS National Map: Orthoimagery, Last refreshed October, 2020.

Note: Some Special Flood Hazard Areas with elevations may not appear with elevation labels if the Base Flood Elevation or Cross-section line which communicates the elevation for the location appears on the adjacent panel. Please see the Panel Locator Diagram on this map panel to determine the adjacent panel and find the elevation feature there, or alternatively use the Flood Insurance Study report for detailed elevations by food source.

This panel contains levee systems that have not been accredited and are therefore not recognized as reducing the 1-percent-annual-chance flood hazard.

SCALE

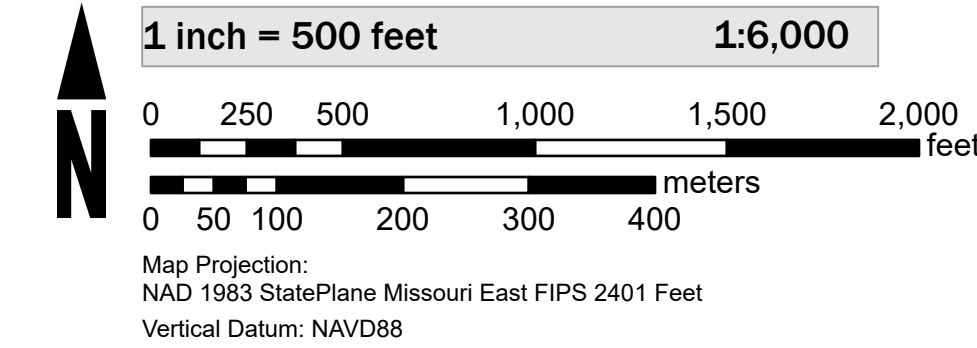

PANEL LOCATOR

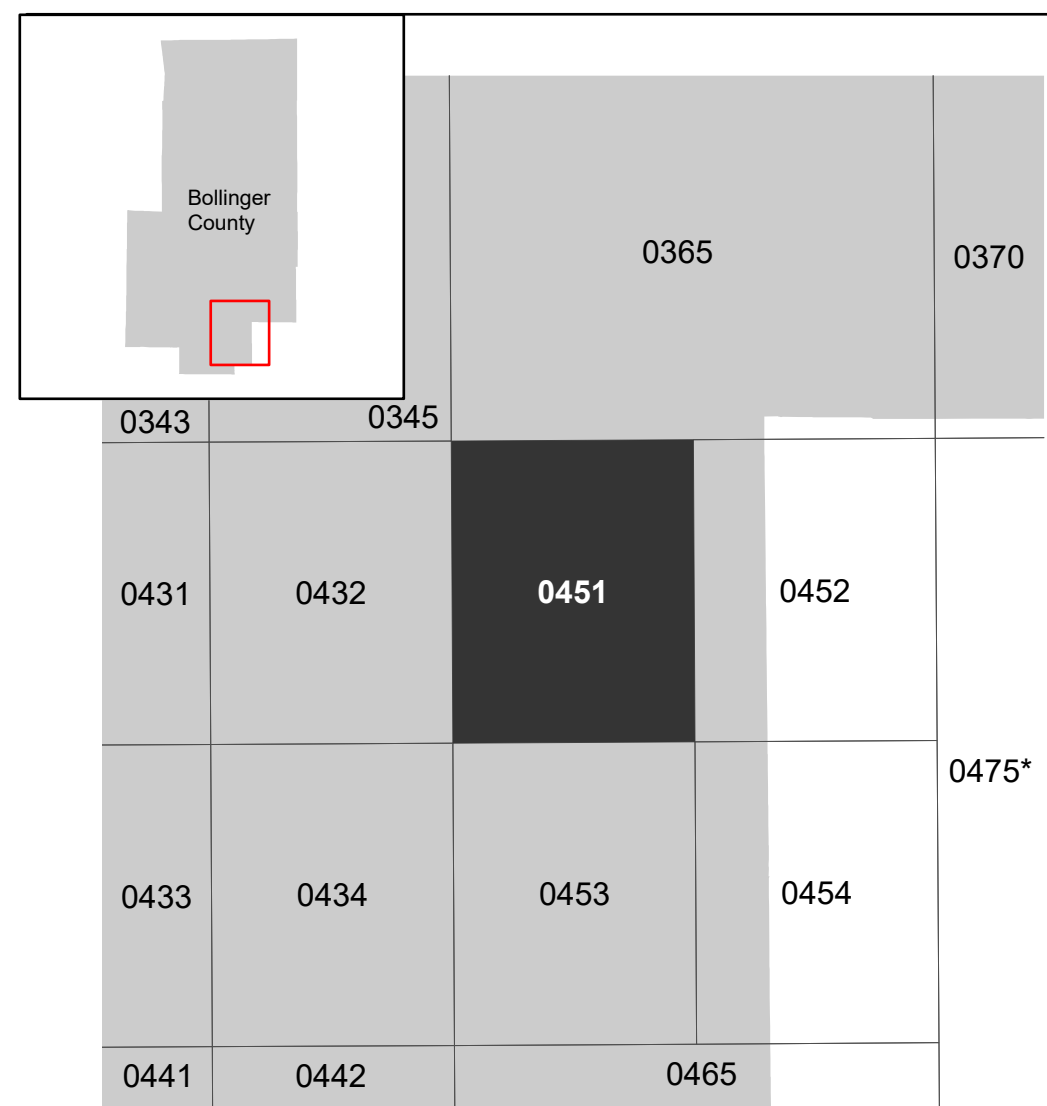

*PANEL NOT PRINTED

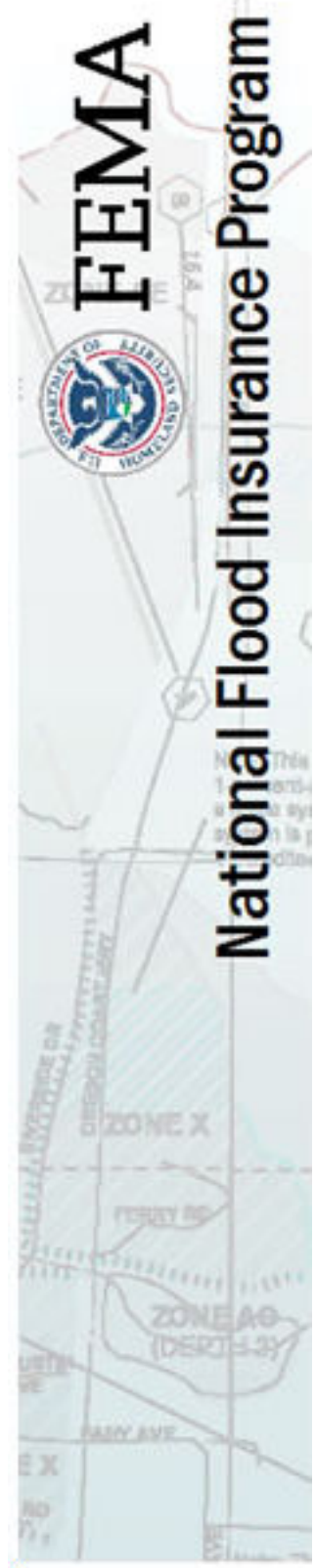

NATIONAL FLOOD INSURANCE PROGRAM
 FLOOD INSURANCE RATE MAP

BOLLINGER COUNTY MISSOURI AND INCORPORATED AREAS



Panel Contains:
COMMUNITY BOLLINGER COUNTY UNINCORPORATED AREAS
NUMBER 290787
PANEL SUFFIX 0451 D

MAP NUMBER
29017C0451D
 EFFECTIVE DATE
 Prelim Issue Date: 08/16/2023