

44° 5'37.53" N,
82° 56'15.02" W

44° 5'37.53" N,
82° 54'22.52" W

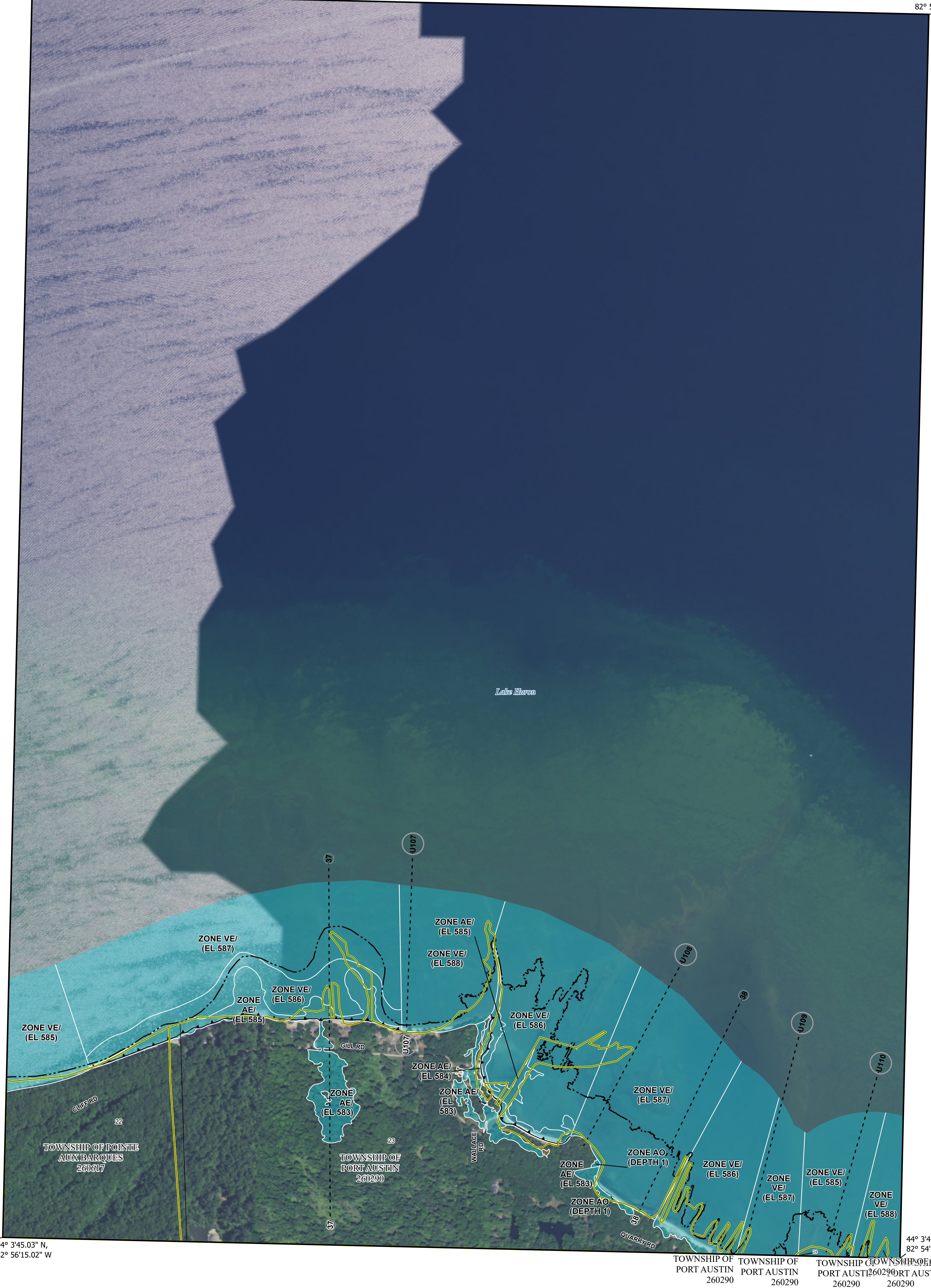

44° 3'45.03" N,
82° 56'15.02" W

TOWNSHIP OF PORT AUSTIN 260290
TOWNSHIP OF PORT AUSTIN 260290
TOWNSHIP OF PORT AUSTIN 260290
TOWNSHIP OF PORT AUSTIN 260290
44° 3'45.03" N,
82° 54'22.52" W

FLOOD HAZARD INFORMATION

SEE FIS REPORT FOR DETAILED LEGEND AND INDEX MAP FOR FIRM PANEL LAYOUT
THE INFORMATION DEPICTED ON THIS MAP AND SUPPORTING DOCUMENTATION ARE ALSO AVAILABLE IN DIGITAL FORMAT AT [HTTPS://MSC.FEMA.GOV](https://msc.fema.gov)

SPECIAL FLOOD HAZARD AREAS		Without Base Flood Elevation (BFE) Zone A, V, A99
		With BFE or Depth Zone AE, AO, AH, VE, AR
OTHER AREAS OF FLOOD HAZARD		Regulatory Floodway
		0.2% Annual Chance Flood Hazard, Areas of 1% annual chance flood with average depth less than one foot or with drainage areas of less than one square mile Zone X
OTHER AREAS		Future Conditions 1% Annual Chance Flood Hazard Zone X
		Area with Reduced Flood Risk due to Levee See Notes Zone X
GENERAL STRUCTURES		Area with Flood Risk due to Levee Zone D
		Area of Minimal Flood Risk Zone X
OTHER FEATURES		Area of Undetermined Flood Hazard Zone D
		Channel, Culvert, or Storm Sewer
OTHER FEATURES		Levee, Dike, or Floodwall
		Cross Sections with 1% Annual Chance 20.2
OTHER FEATURES		Water Surface Elevation 17.5
		Coastal Transect
OTHER FEATURES		Coastal Transect Baseline
		Profile Baseline
OTHER FEATURES		Hydrographic Feature
		Base Flood Elevation Line (BFE)
OTHER FEATURES		Limit of Study
		Jurisdiction Boundary

NOTES TO USERS

For information and questions about this Flood Insurance Rate Map (FIRM), available effective flood hazard information for your community, or the National Flood Insurance Program (NFIP) in general, please call the FEMA Mapping and Insurance Information Exchange at 1-877-FEMA-MAP (1-877-336-2627) or visit the FEMA Flood Map Service Center website at <https://msc.fema.gov>. Available products may include previously issued Letters of Map Change, a Flood Insurance Study Report, and/or digital versions of this map. Many of these products can be downloaded from the website. Communities annexing land on adjacent FIRM panels must obtain a current copy of the adjacent panel as well as the current FIRM Index. These may be acquired directly from the Flood Map Service Center at the website listed above.

For community and countywide map dates refer to the Flood Insurance Study Report for this jurisdiction.

To determine if flood insurance is available in this community, contact your insurance agent or call the National Flood Insurance Program at 1-800-638-6620.

Basemap information shown on this FIRM was provided in digital format by the United States Geological Survey (USGS). The basemap shown is the USGS National Map: Orthoimagery, Last refreshed October, 2020.

Note: Some Special Flood Hazard Areas with elevations may not appear with elevation labels if the Base Flood Elevation or Cross-section line which communicates the elevation for the location appears on the adjacent panel. Please see the Panel Locator Diagram on this map panel to determine the adjacent panel and find the elevation feature there, or alternatively use the Flood Insurance Study report for detailed elevations by flood source.

Limit of Moderate Wave Action (LIMWA)
LIMIT OF MODERATE WAVE ACTION: Zone AE has been divided by a Limit of Moderate Wave Action (LIMWA). The LIMWA represents the approximate landward limit of the 1.5-foot breaking wave. The effects of wave hazards between Zone VE and the LIMWA (or between the shoreline and the LIMWA for areas where Zone VE is not identified) will be similar to, but less severe than, those in Zone VE.

SCALE

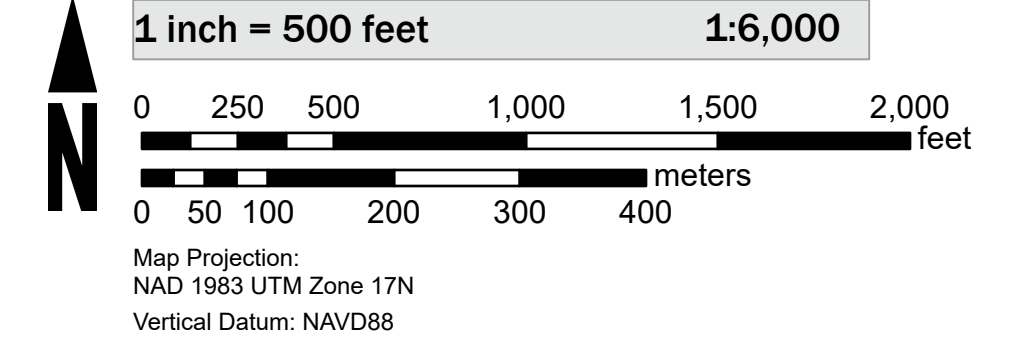

PANEL LOCATOR

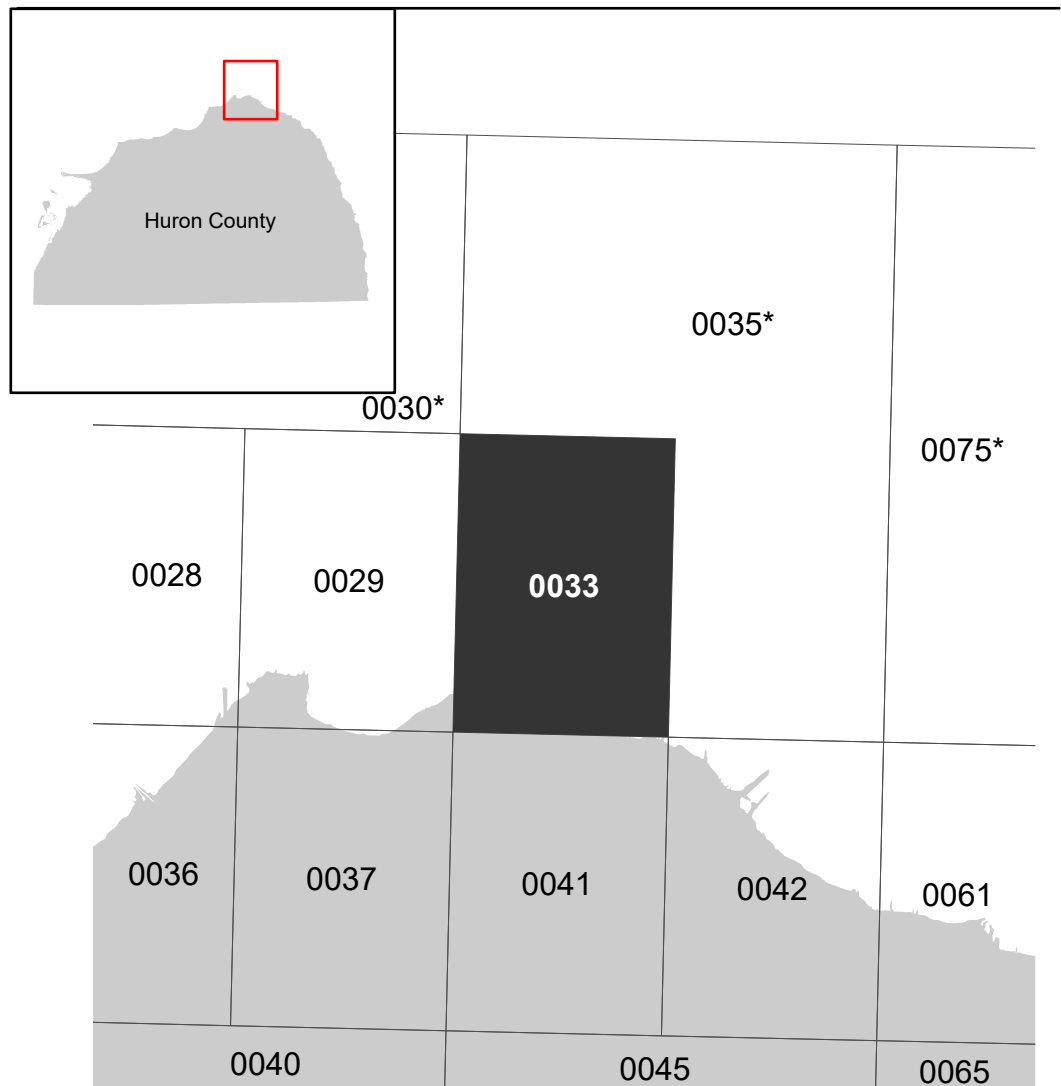

*PANEL NOT PRINTED



NATIONAL FLOOD INSURANCE PROGRAM FLOOD INSURANCE RATE MAP

HURON COUNTY
MICHIGAN
ALL JURISDICTIONS

Panel Contains:

COMMUNITY	NUMBER	PANEL SUFFIX
TOWNSHIP OF POINTE AUX BARQUES	260617	0033 E
TOWNSHIP OF PORT AUSTIN	260290	0033 E

MAP NUMBER
26063C0033E
EFFECTIVE DATE
Prelim Issue Date: 11/30/2023