

FLOOD HAZARD INFORMATION

SEE FIS REPORT FOR DETAILED LEGEND AND INDEX MAP FOR FIRM PANEL LAYOUT
THE INFORMATION DEPICTED ON THIS MAP AND SUPPORTING DOCUMENTATION ARE ALSO AVAILABLE IN DIGITAL FORMAT AT [HTTPS://MSC.FEMA.GOV](https://MSC.FEMA.GOV)

- SPECIAL FLOOD HAZARD AREAS**
 - Without Base Flood Elevation (BFE) Zone A, V, A99
 - With BFE or Depth Zone AE, AO, AH, VE, AR
 - Regulatory Floodway
- OTHER AREAS OF FLOOD HAZARD**
 - 0.2% Annual Chance Flood Hazard, Areas of 1% annual chance flood with average depth less than one foot or with drainage areas of less than one square mile Zone X
 - Future Conditions 1% Annual Chance Flood Hazard Zone X
 - Area with Reduced Flood Risk due to Levee See Notes Zone X
 - Area with Flood Risk due to Levee Zone D
 - Area of Minimal Flood Hazard Zone X
 - Area of Undetermined Flood Hazard Zone D
- OTHER AREAS**
 - Channel, Culvert, or Storm Sewer
 - Levee, Dike, or Floodwall
 - Cross Sections with 1% Annual Chance 20.2
 - Water Surface Elevation 17.5
 - Coastal Transect 8
 - Coastal Transect Baseline
 - Profile Baseline
 - Hydrographic Feature
 - Base Flood Elevation Line (BFE)
- OTHER FEATURES**
 - Limit of Study
 - Jurisdiction Boundary

NOTES TO USERS

For information and questions about this Flood Insurance Rate Map (FIRM), available effective flood hazard information for your community, or the National Flood Insurance Program (NFIP) in general, please call the FEMA Mapping and Insurance Information Exchange at 1-877-FEMA-MAP (1-877-336-2627) or visit the FEMA Flood Map Service Center website at <https://msc.fema.gov>. Available products may include previously issued Letters of Map Change, a Flood Insurance Study Report, and/or digital versions of this map. Many of these products can be downloaded from the website. Communities annexing land on adjacent FIRM panels must obtain a current copy of the adjacent panel as well as the current FIRM Index. These may be acquired directly from the Flood Map Service Center at the website listed above.

For community and countywide map dates refer to the Flood Insurance Study Report for this jurisdiction.

To determine if flood insurance is available in this community, contact your insurance agent or call the National Flood Insurance Program at 1-800-638-6620.

Basemap information shown on this FIRM was provided in digital format by the United States Geological Survey (USGS). The basemap shown is the USGS National Map: Orthoimagery, Last refreshed October, 2020.

SCALE

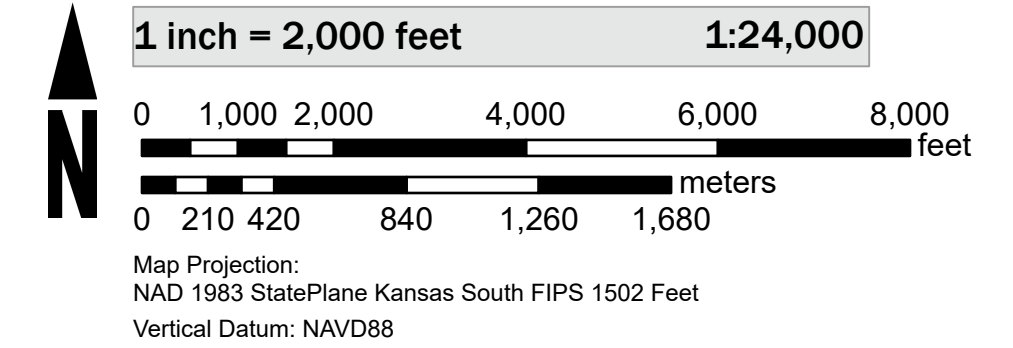

PANEL LOCATOR

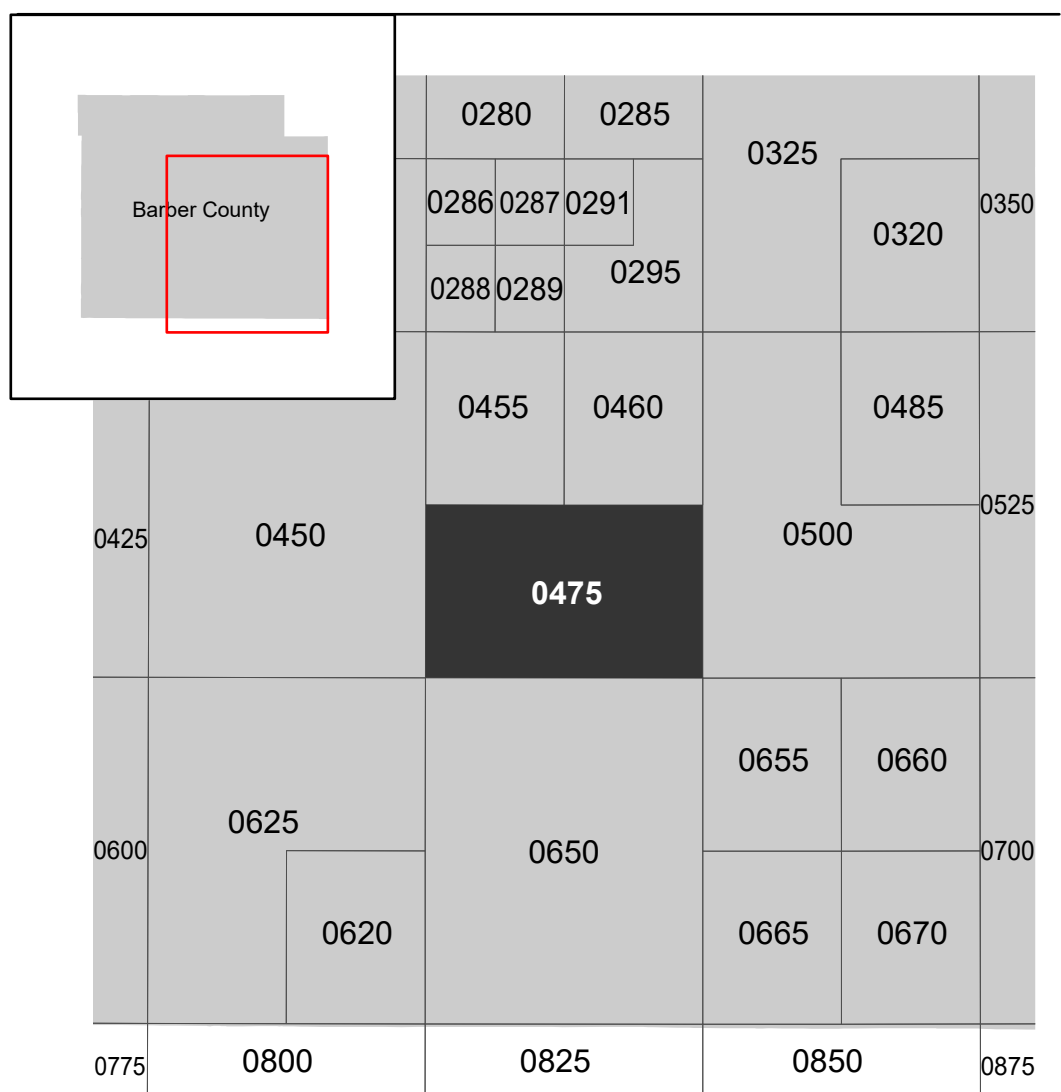

National Flood Insurance Program

NATIONAL FLOOD INSURANCE PROGRAM
 FLOOD INSURANCE RATE MAP

BARBER COUNTY KANSAS AND INCORPORATED AREAS

Panel Contains:

COMMUNITY	NUMBER	PANEL SUFFIX
BARBER COUNTY UNINCORPORATED AREAS	200570	0475 C

MAP NUMBER
20007C0475C
 EFFECTIVE DATE
Prelim Issue Date: 06/23/2023