

FLOOD HAZARD INFORMATION

SEE FIS REPORT FOR DETAILED LEGEND AND INDEX MAP FOR FIRM PANEL LAYOUT
THE INFORMATION DEPICTED ON THIS MAP AND SUPPORTING DOCUMENTATION ARE ALSO AVAILABLE IN DIGITAL FORMAT AT [HTTPS://MSC.FEMA.GOV](https://msc.fema.gov)

SPECIAL FLOOD HAZARD AREAS		Without Base Flood Elevation (BFE) Zone A, V, A99
		With BFE or Depth Zone AE, AO, AH, VE, AR
		Regulatory Floodway
OTHER AREAS OF FLOOD HAZARD		0.2% Annual Chance Flood Hazard, Areas of 1% annual chance flood with average depth less than one foot or with drainage areas of less than one square mile Zone X
		Future Conditions 1% Annual Chance Flood Hazard Zone X
		Area with Reduced Flood Risk due to Levee See Notes, Zone X
		Area with Flood Risk due to Levee Zone D
OTHER AREAS		NO SCREEN Areas of Minimal Flood Hazard Zone X
		Area of Undetermined Flood Hazard Zone D
GENERAL STRUCTURES		Channel, Culvert, or Storm Sewer
		Levee, Dike, or Floodwall
OTHER FEATURES		18.2 17.5 Cross Sections with 1% Annual Chance Water Surface Elevation
		Coastal Transect
		Coastal Transect Baseline
		Profile Baseline
		Hydrographic Feature
		Base Flood Elevation Line (BFE)
		Limit of Study
		Jurisdiction Boundary

NOTES TO USERS

For information and questions about this Flood Insurance Rate Map (FIRM), available products associated with this FIRM, including historic versions, the current map date for each FIRM panel, how to order products, or the National Flood Insurance Program (NFIP) in general, please call the FEMA Mapping and Insurance eExchange at 1-877-FEMA-MAP (1-877-336-2627) or visit the FEMA Flood Map Service Center website at <https://msc.fema.gov>. Available products may include previously issued Letters of Map Change, a Flood Insurance Study Report, and/or digital versions of this map. Many of these products can be ordered or obtained directly from the website.

Communities annexing land on adjacent FIRM panels must obtain a current copy of the adjacent panel as well as the current FIRM index. These may be ordered directly from the Flood Map Service Center at the number listed above.

For community and countywide map dates refer to the Flood Insurance Study Report for this jurisdiction. To determine if flood insurance is available in this community, contact your insurance agent or call the National Flood Insurance Program at 1-800-638-6620.

Base map information shown on this FIRM was provided in digital format by the United States Geological Survey (USGS). This information was derived from digital orthophotography at a 2-foot resolution from photography dated 2019.

SCALE

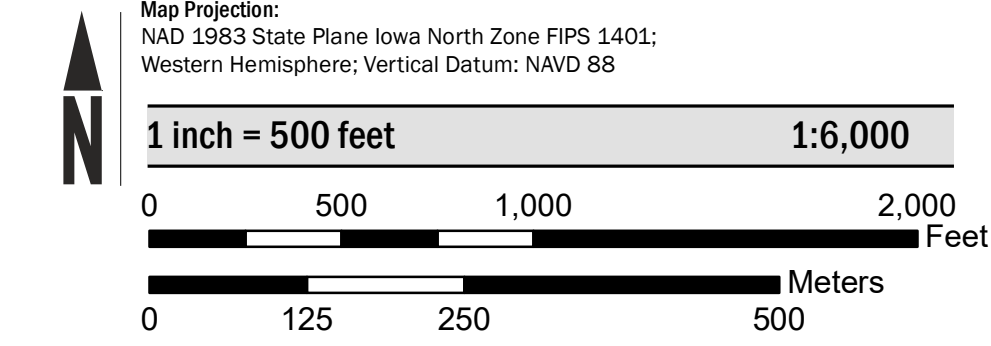

PANEL LOCATOR

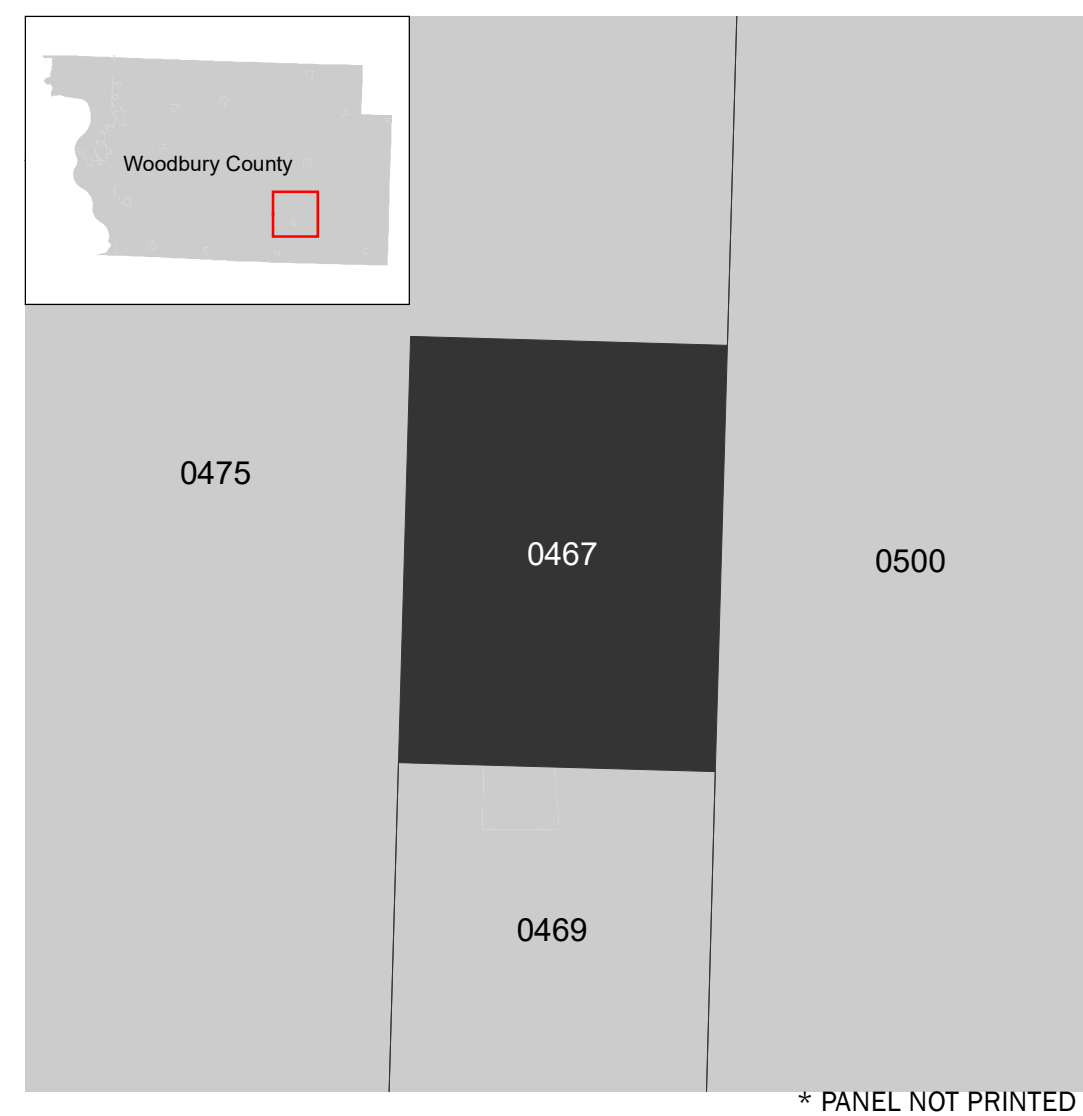

FEMA
 National Flood Insurance Program

**NATIONAL FLOOD INSURANCE PROGRAM
 FLOOD INSURANCE RATE MAP**

WOODBURY COUNTY, IOWA
 And Incorporated Areas

PANEL 467 of 675

Panel Contains:

COMMUNITY	NUMBER	PANEL	SUFFIX
OTO, CITY OF	190294	0467	E
WOODBURY COUNTY	190536	0467	E

**REVISED
 PRELIMINARY
 7/8/2022**

VERSION NUMBER
 2.6.1.1

MAP NUMBER
 19193C0467E

MAP REVISED