

**FLOOD HAZARD INFORMATION**

SEE FIS REPORT FOR DETAILED LEGEND AND INDEX MAP FOR FIRM PANEL LAYOUT  
**THE INFORMATION DEPICTED ON THIS MAP AND SUPPORTING DOCUMENTATION ARE ALSO AVAILABLE IN DIGITAL FORMAT AT [HTTPS://MSC.FEMA.GOV](https://MSC.FEMA.GOV)**

SPECIAL FLOOD HAZARD AREAS		Without Base Flood Elevation (BFE)
		With BFE or Depth Zone AE, AO, AH, VE, AR
OTHER AREAS OF FLOOD HAZARD		Regulatory Floodway
		0.2% Annual Chance Flood Hazard, Areas of 1% annual chance flood with average depth less than one foot or with drainage areas of less than one square mile Zone X
OTHER AREAS		Future Conditions 1% Annual Chance Flood Hazard Zone X
		Area with Reduced Flood Risk due to Levee See Notes Zone X
GENERAL STRUCTURES		Area with Flood Risk due to Levee Zone D
		NO SCREEN Area of Minimal Flood Hazard Zone X
OTHER FEATURES		Area of Undetermined Flood Hazard Zone D
		Channel, Culvert, or Storm Sewer
OTHER FEATURES		Dam, Jetty, or Weir
		Levee, Dike or Floodwall
OTHER FEATURES		Cross Sections with 1% Annual Chance Water Surface Elevation (BFE) 718.7 717.5
		Coastal Transect
OTHER FEATURES		Coastal Transect Baseline
		Profile Baseline
OTHER FEATURES		Hydrographic Feature
		Base Flood Elevation Line (BFE)
OTHER FEATURES		Limit of Study
		Jurisdiction Boundary

**NOTES TO USERS**

For information and questions about this Flood Insurance Rate Map (FIRM), available products associated with this FIRM, including historic versions, the current map date for each FIRM panel, how to order products, or the National Flood Insurance Program (NFIP) in general, please call the FEMA Map Information eXchange at 1-877-FEMA-MAP (1-877-336-2627) or visit the FEMA Flood Map Service Center website at <https://msc.fema.gov>. Available products may include previously issued Letters of Map Change, a Flood Insurance Study Report, and/or digital versions of this map. Many of these products can be ordered or obtained directly from the website.

Communities annexing land on adjacent FIRM panels must obtain a current copy of the adjacent panel as well as the current FIRM index. These may be ordered directly from the Flood Map Service Center at the number listed above.

For community and countywide map dates refer to the Flood Insurance Study report for this jurisdiction.

To determine if flood insurance is available in this community, contact your insurance agent or call the National Flood Insurance Program at 1-800-638-6620.

Base map information shown on this FIRM was provided in digital format by the Illinois Department of Transportation. This information was derived from digital orthorectified aerial photography at a spatial resolution of 1 foot from aerial photography dated Spring 2015.

ILLINOIS  
 Illinois State Water Survey  
 PRAIRIE RESEARCH INSTITUTE

**SCALE**

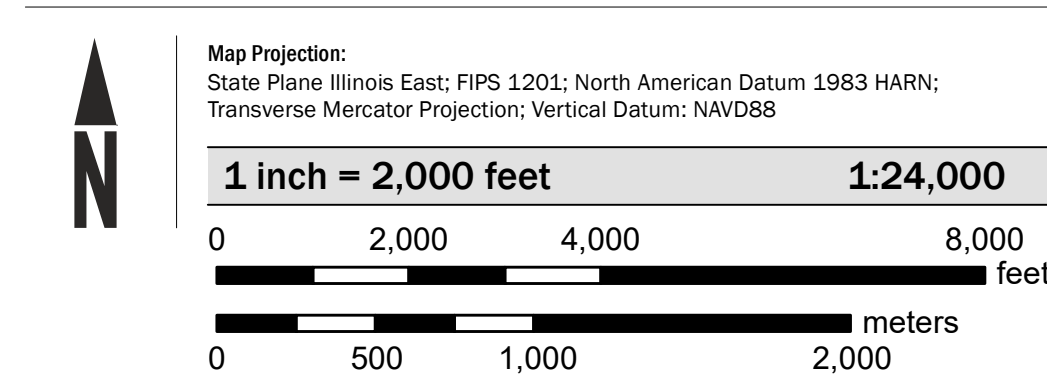

**PANEL LOCATOR**

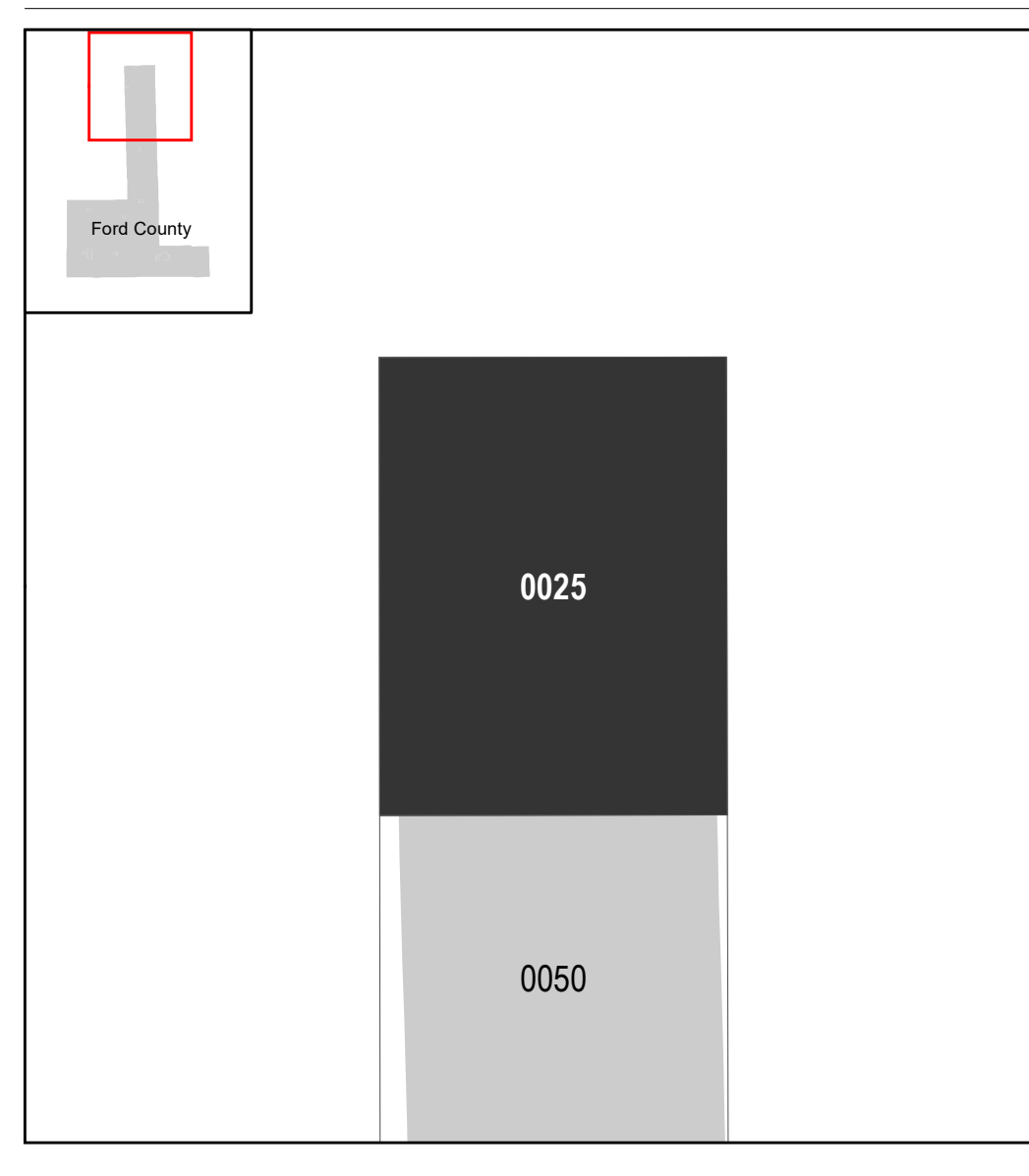

**NATIONAL FLOOD INSURANCE PROGRAM**  
 FLOOD INSURANCE RATE MAP

FORD COUNTY, ILLINOIS  
 and Incorporated Areas

PANEL 25 OF 325



COMMUNITY	NUMBER	PANEL	SUFFIX
CABERY, VILLAGE OF	171116	0025	B
FORD COUNTY	170991	0025	B
KEMPTON, VILLAGE OF	171118	0025	B

**PRELIMINARY**  
 10/1/2019

VERSION NUMBER  
 2.5.3.6  
 MAP NUMBER  
 17053C0025B  
 EFFECTIVE DATE