

31° 39'22.52" N,  
110° 18'45.04" W

Cochise County  
Unincorporated Areas  
040012

31° 39'22.52" N,  
110° 16'52.54" W

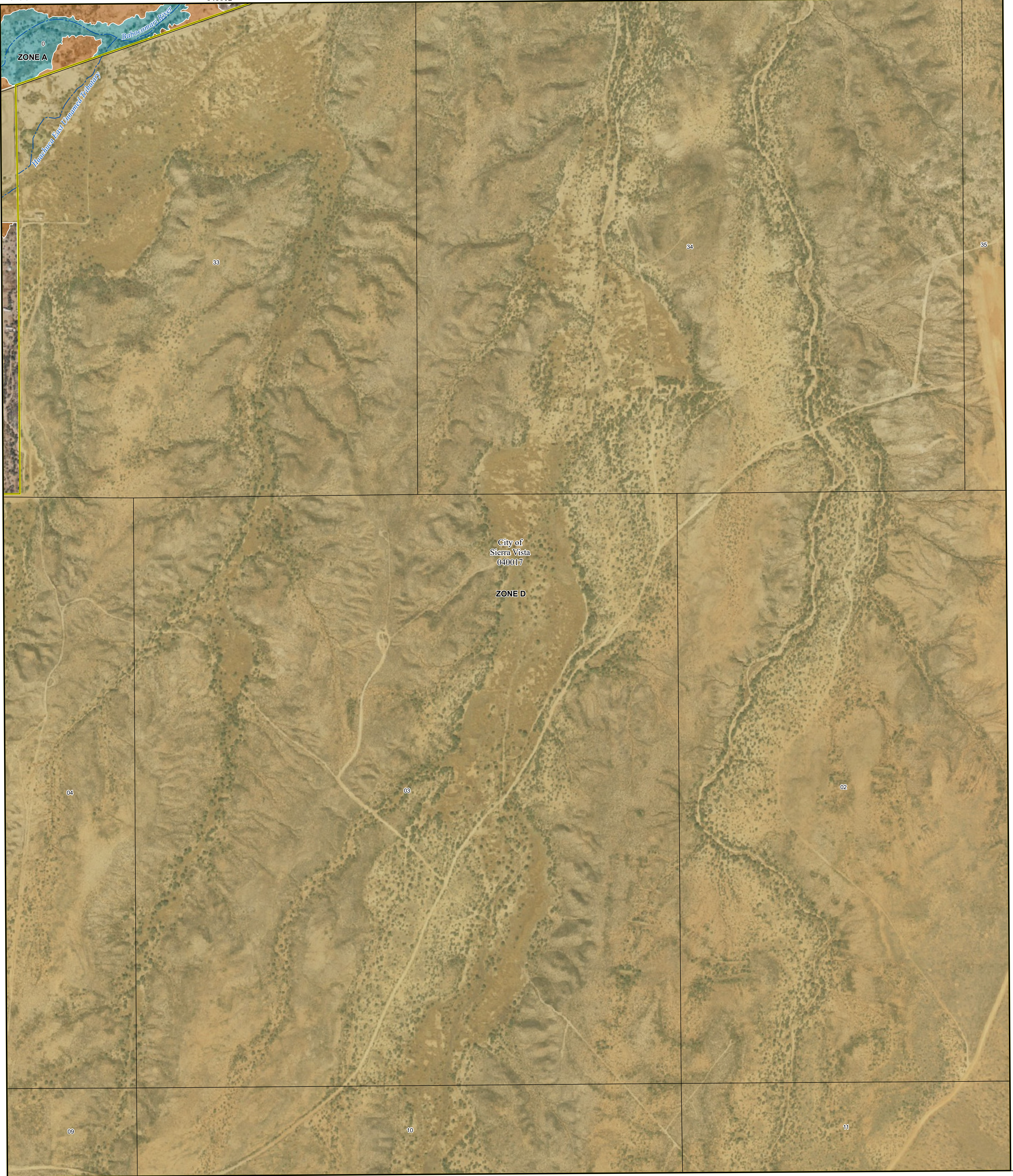

31° 37'30.02" N,  
110° 18'45.04" W

31° 37'30.02" N,  
110° 16'52.54" W

### FLOOD HAZARD INFORMATION

SEE FIS REPORT FOR DETAILED LEGEND AND INDEX MAP FOR FIRM PANEL LAYOUT  
THE INFORMATION DEPICTED ON THIS MAP AND SUPPORTING DOCUMENTATION ARE ALSO AVAILABLE IN DIGITAL FORMAT AT [HTTPS://MSC.FEMA.GOV](https://MSC.FEMA.GOV)

SPECIAL FLOOD HAZARD AREAS		Without Base Flood Elevation (BFE) Zone A, V, AE, AR
		With BFE or Depth Zone AE, AO, AH, VE, AR
OTHER AREAS OF FLOOD HAZARD		Regulatory Floodway
		0.2% Annual Chance Flood Hazard, Areas of 1% annual chance flood with average depth less than one foot or with drainage areas of less than one square mile Zone X
		Future Conditions 1% Annual Chance Flood Hazard Zone X
OTHER AREAS		Area with Reduced Flood Risk due to Levee See Notes Zone X
		Area with Flood Risk due to Levee Zone D
GENERAL STRUCTURES		NO SCREEN Area of Minimal Flood Hazard Zone X
		Area of Undetermined Flood Hazard Zone D
OTHER FEATURES		Channel, Culvert, or Storm Sewer
		Levee, Dike, or Floodwall
OTHER FEATURES		Cross Sections with 1% Annual Chance
		Water Surface Elevation
OTHER FEATURES		Coastal Transect
		Coastal Transect Baseline
OTHER FEATURES		Profile Baseline
		Hydrographic Feature
OTHER FEATURES		Base Flood Elevation Line (BFE)
		Limit of Study
OTHER FEATURES		Jurisdiction Boundary

### NOTES TO USERS

For information and questions about this Flood Insurance Rate Map (FIRM), available effective flood hazard information for your community, or the National Flood Insurance Program (NFIP) in general, please call the FEMA Mapping and Insurance eXchange at 1-877-FEMA-MAP (1-877-336-2627) or visit the FEMA Flood Map Service Center website at <https://msc.fema.gov>. Available products may include previously issued Letters of Map Change, a Flood Insurance Study Report, and/or digital versions of this map. Many of these products can be downloaded from the website. Communities annexing land on adjacent FIRM panels must obtain a current copy of the adjacent panel as well as the current FIRM Index. These may be acquired directly from the Flood Map Service Center at the website listed above.

For community and countywide map dates refer to the Flood Insurance Study Report for this jurisdiction. To determine if flood insurance is available in this community, contact your insurance agent or call the National Flood Insurance Program at 1-800-638-6620.

Basemap information shown on this FIRM was provided in digital format by the United States Geological Survey (USGS). The basemap shown is the USGS National Map: Orthimagery, Last refreshed October, 2020.

Note: Some Special Flood Hazard Areas with elevations may not appear with elevation labels if the Base Flood Elevation or Cross-section line which communicates the elevation for the location appears on the adjacent panel. Please see the Panel Locator Diagram on this map panel to determine the adjacent panel and find the elevation feature there, or alternatively use the Flood Insurance Study report for detailed elevations by flood source.

### SCALE

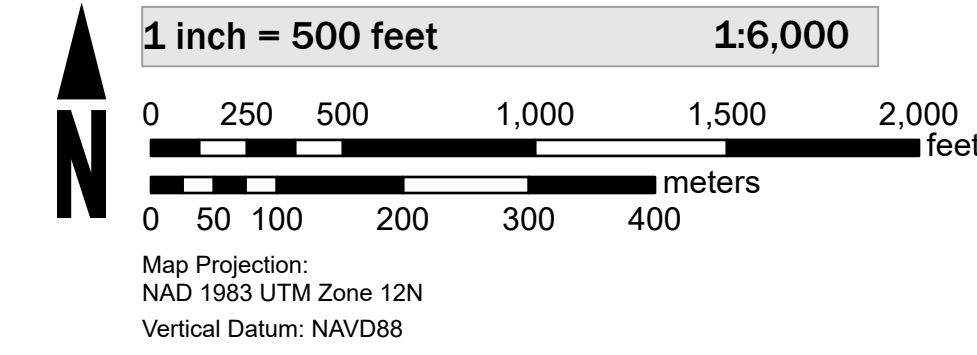

### PANEL LOCATOR

Cochise County		1829	1833	1834	1855
			1841		
1836	1837		1845	1875	
1838	1839	1843			
2126	2127	2131*	2132*	2151*	
2128*	2129*	2133	2134	2153	

\*PANEL NOT PRINTED

National Flood Insurance Program

**NATIONAL FLOOD INSURANCE PROGRAM**  
FLOOD INSURANCE RATE MAP

**COCHISE COUNTY**  
ARIZONA  
AND INCORPORATED  
AREAS

Panel Contains:

COMMUNITY	NUMBER	PANEL	SUFFIX
CITY OF SIERRA VISTA	040017	1843	G
COCHISE COUNTY UNINCORPORATED AREAS	040012	1843	G

MAP NUMBER  
**04003C1843G**  
EFFECTIVE DATE  
Prelim Issue Date: 10/11/2024