

FLOOD HAZARD INFORMATION

SEE FIS REPORT FOR DETAILED LEGEND AND INDEX MAP FOR FIRM PANEL LAYOUT
THE INFORMATION DEPICTED ON THIS MAP AND SUPPORTING DOCUMENTATION ARE ALSO AVAILABLE IN DIGITAL FORMAT AT [HTTPS://MSC.FEMA.GOV](https://MSC.FEMA.GOV)

SPECIAL FLOOD HAZARD AREAS		Without Base Flood Elevation (BFE) Zone A, V, A99
		With BFE or Depth Zone AE, AO, AH, VE, AR
		Regulatory Floodway
OTHER AREAS OF FLOOD HAZARD		0.2% Annual Chance Flood Hazard, Areas of 1% annual chance flood with average depth less than one foot or with drainage areas of less than one square mile Zone X
		Future Conditions 1% Annual Chance Flood Hazard Zone X
		Area with Reduced Flood Risk due to Levee See Notes Zone X
		Area with Flood Risk due to Levee Zone D
OTHER AREAS		Area of Minimal Flood Hazard Zone X
		Area of Undetermined Flood Hazard Zone D
GENERAL STRUCTURES		Channel, Culvert, or Storm Sewer
		Levee, Dike, or Floodwall
		Cross Sections with 1% Annual Chance Water Surface Elevation (BFE)
		Coastal Transect
		Coastal Transect Baseline
		Profile Baseline
		Hydrographic Feature
		Base Flood Elevation Line (BFE)
OTHER FEATURES		Limit of Study
		Jurisdiction Boundary

NOTES TO USERS

For information and questions about this Flood Insurance Rate Map (FIRM), available products associated with this FIRM, including historic versions of this FIRM, the current map date for each FIRM panel, how to order products, or the National Flood Insurance Program in general, please call the FEMA Map Information eXchange at 1-877-FEMA-MAP (1-877-336-2627) or visit the FEMA Map Service Center website at <http://msc.fema.gov>. Available products may include previously issued Letters of Map Change, a Flood Insurance Study Report, and/or digital versions of this map. Many of these products can be ordered or obtained directly from the website.

Communities annexing land on adjacent FIRM panels must obtain a current copy of the adjacent panel as well as the current FIRM index. These may be ordered directly from the Map Service Center at the number listed above.

For community and countywide map dates refer to the Flood Insurance Study report for this jurisdiction.

To determine if flood insurance is available in this community, contact your insurance agent or call the National Flood Insurance Program at 1-800-638-6620.

Base map information shown on this FIRM was derived from multiple sources. This information was photogrammetrically compiled at a scale of 1"=400' from aerial photography dated 2017.



In cooperation with the Federal Emergency Management Agency (FEMA) and local communities in Alabama, this Flood Insurance Rate Map (FIRM) was developed by the Alabama Office of Water Resources in a digital statewide format to assist communities in their efforts to minimize the loss of property and life through effectively managing development in flood-prone areas. The State of Alabama has implemented a long term approach to floodplain management to reduce the impacts of flooding. This is demonstrated by the State's commitment to mapping floodplain areas at the local level. As part of this effort, the Alabama Office of Water Resources is working closely with FEMA as a Cooperating Technical Partner to produce and maintain this digital FIRM.

Please visit www.adeca.alabama.gov/floods for more information.

SCALE

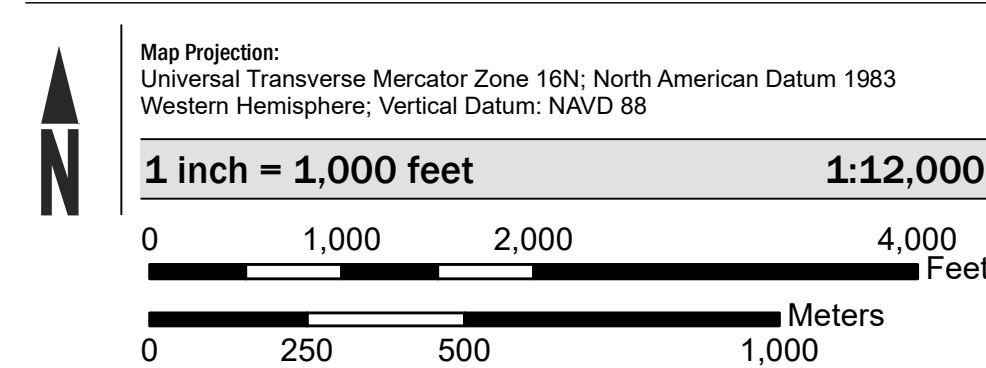

PANEL LOCATOR

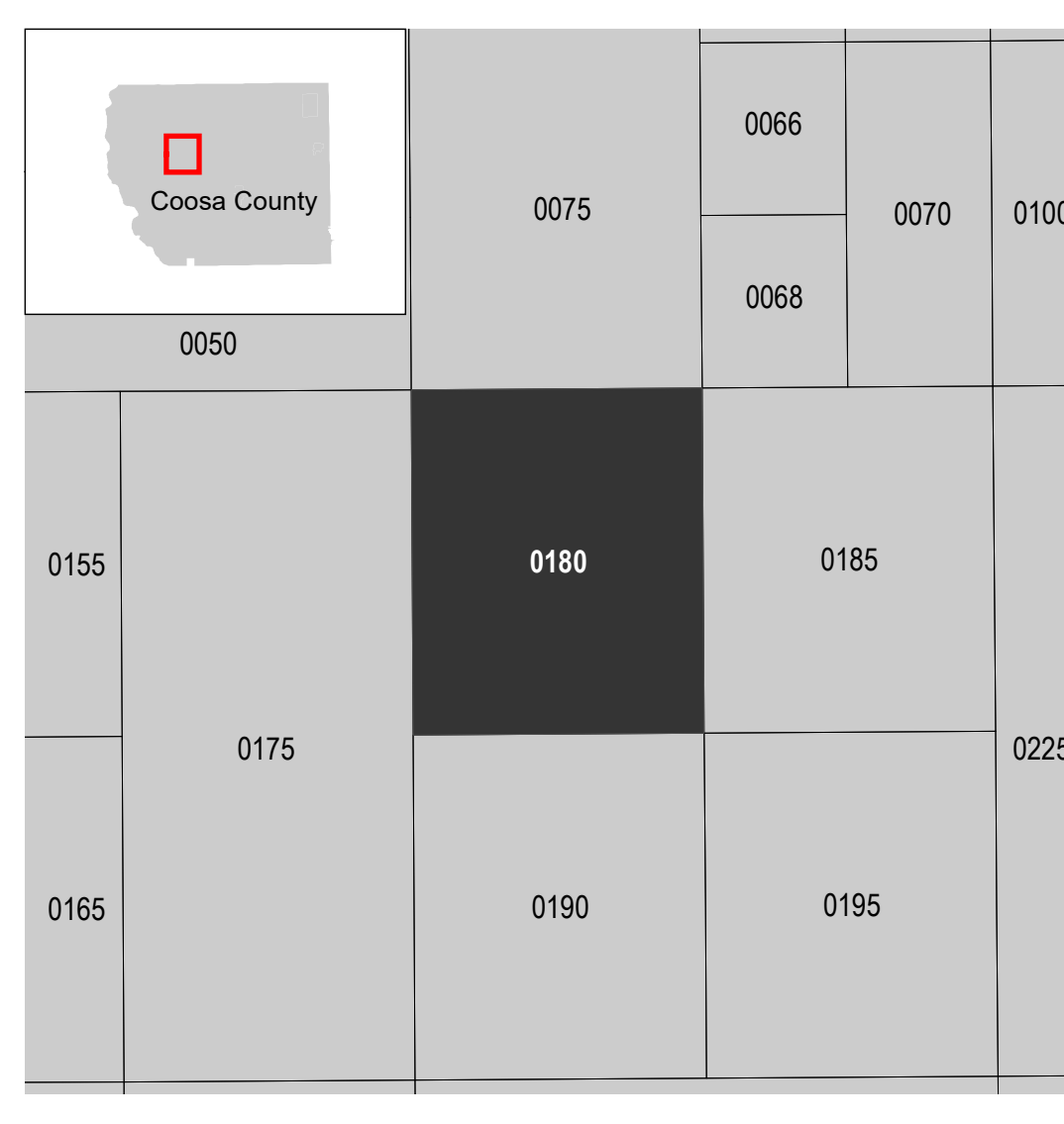

NATIONAL FLOOD INSURANCE PROGRAM

FLOOD INSURANCE RATE MAP

COOSA COUNTY, ALABAMA and Incorporated Areas

PANEL 180 of 375

Panel Contains:

COMMUNITY	NUMBER	PANEL	SUFFIX
COOSA COUNTY	010052	0180	D

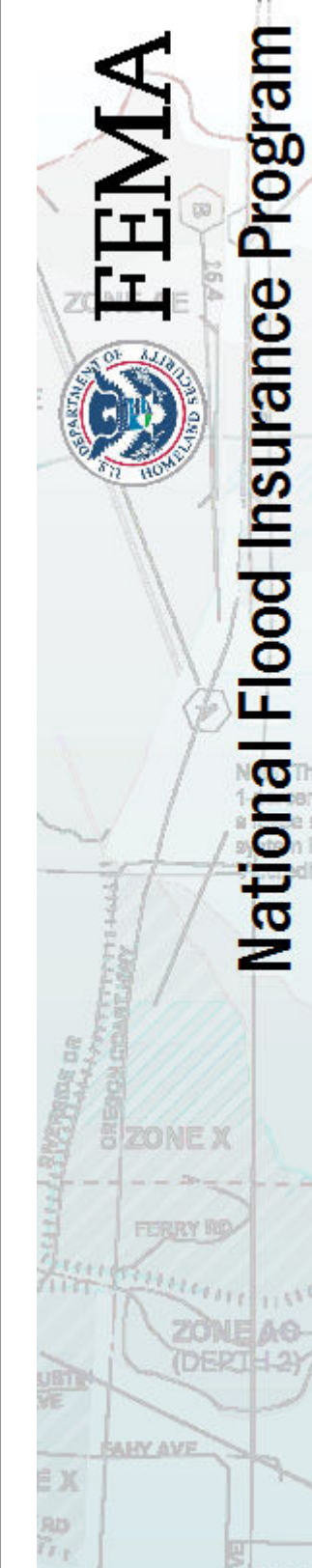

PRELIMINARY
5/8/2020

VERSION NUMBER

2.4.3.5

MAP NUMBER

01037C0180D

MAP REVISED